

Mareazul

AT GRAND CORAL RIVIERA MAYA

Playa Del Carmen

Welcome to Mareazul

A Unique Development of Luxury
Apartments in front of the
Caribbean Sea



Location

Live surrounded by the natural wealth that makes this area the most important *tourist destination* in Mexico.

30 minutes from the Cancun airport, in the city of Playa del Carmen and with direct access from 5th Avenue.

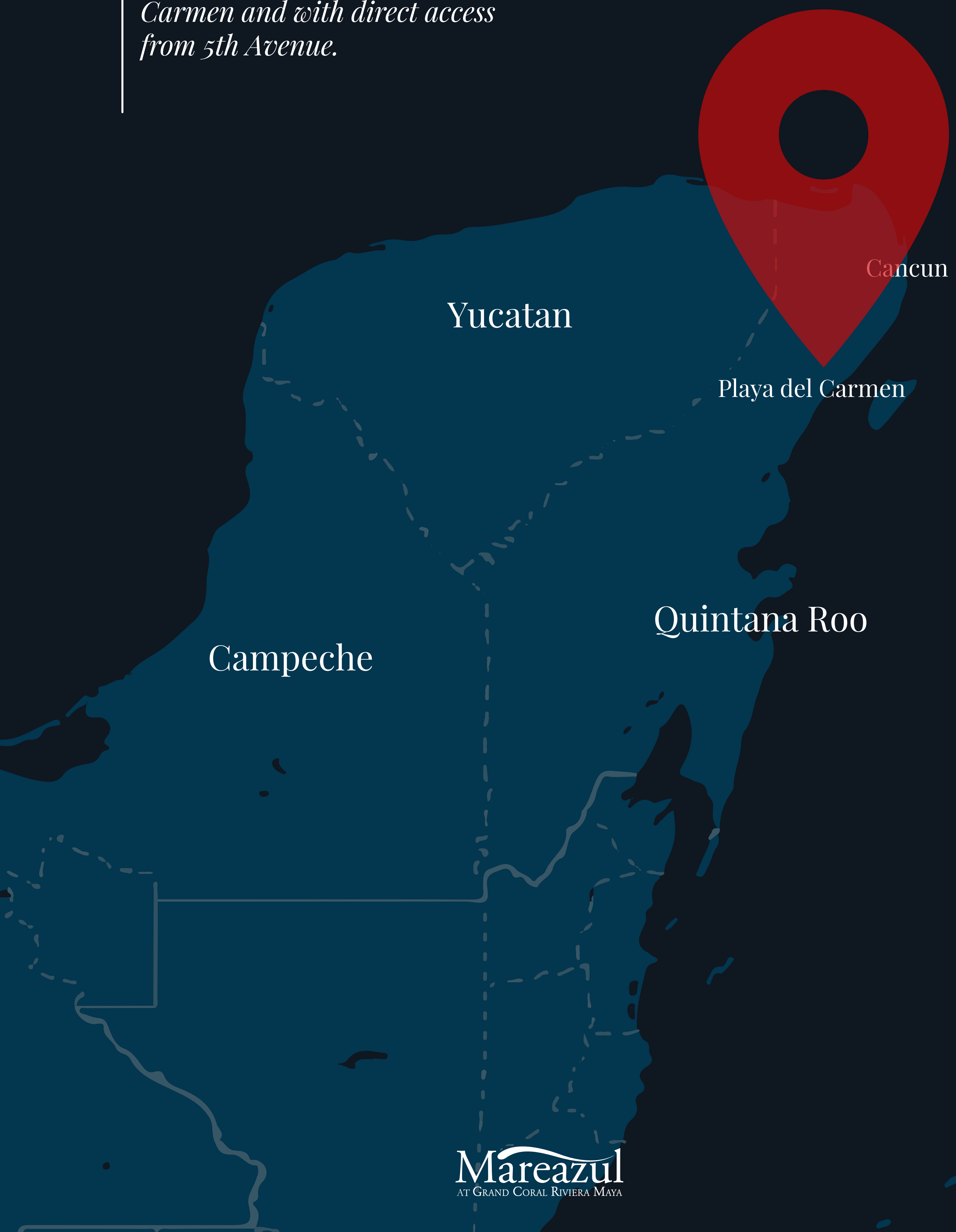





Amenities



Beach Club



Luxury Finishes



Golf Course



Fitness Center



Large Terraces with
Private Jacuzzi



Botanical Garden
with Mayan
Sculptures



Magnificent Sea and
Gardens Views



Tennis and Paddle
Courts



More than 200m of
Beach Front



Spa for Men and
Women



More than 3,000m²
of Swimming Pool



24 hour security

Beach Club

In the beach club you will live an excellent service experience, having at your disposal: swimming pool, baths, sun beds, towels, umbrellas, massage area, diving and snorkeling.



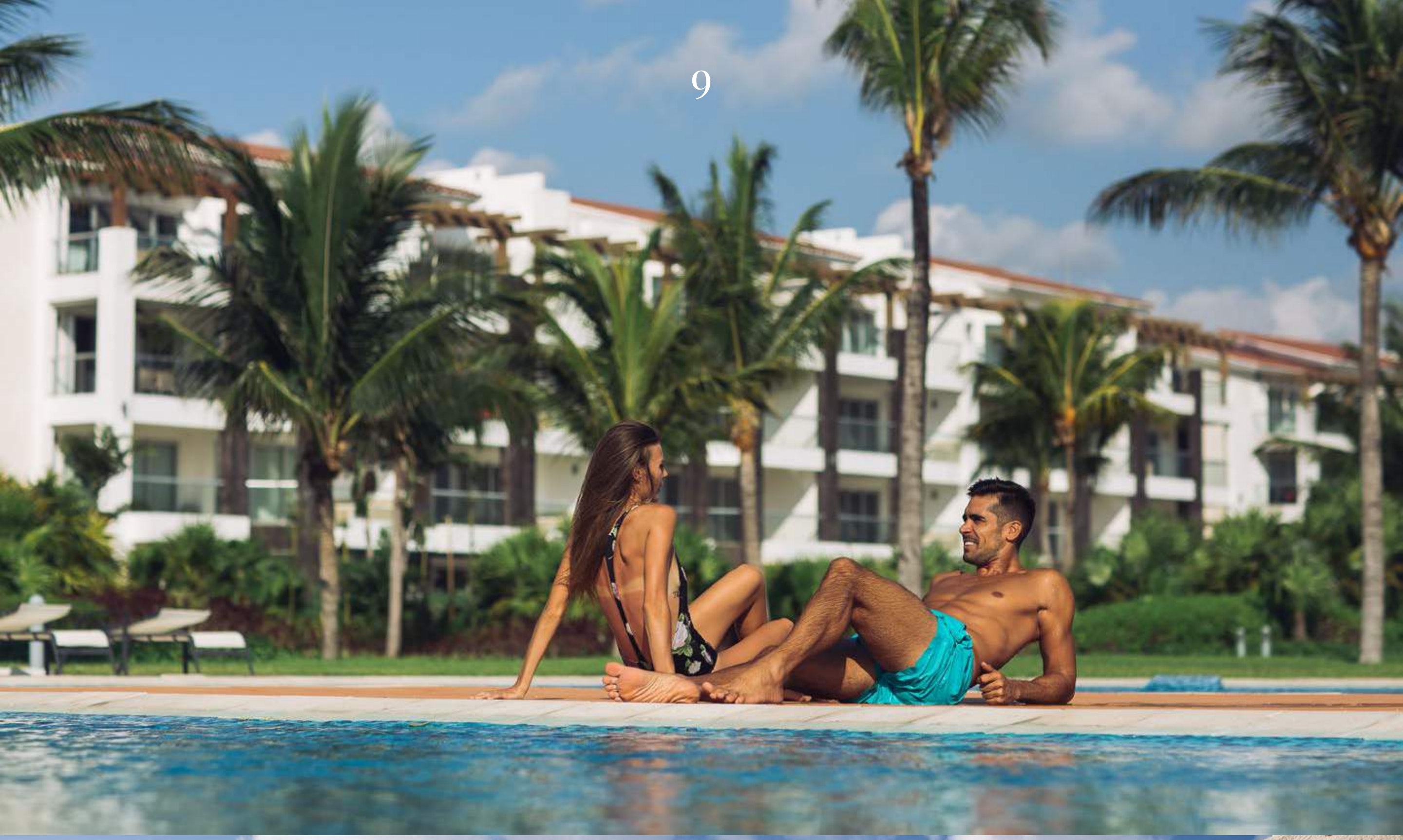

Golf Course

Membership included to owners for the Golf Course designed by the legend of the PGA. It has 18 holes, practice shot and green.

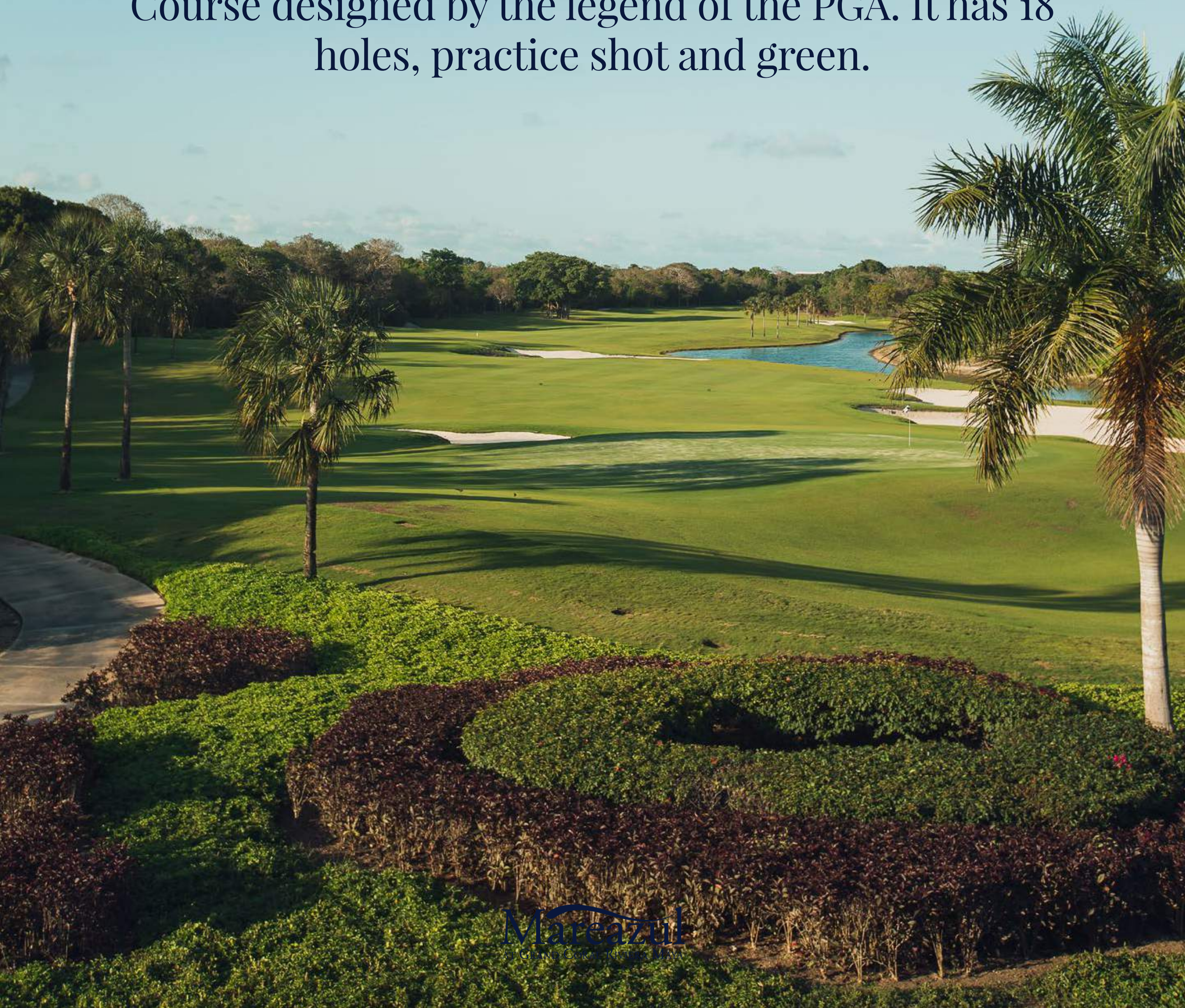



More than 200m of Beach Front

Enjoy oceanfront living like never before in these 200 m of beach front in one of the best locations of the Riviera Maya a few steps from your residence



Mareazul
AT GRAND CORAL RIVIERA MAYA





Immediate Occupancy
Our properties are completely
finished and ready to move into.

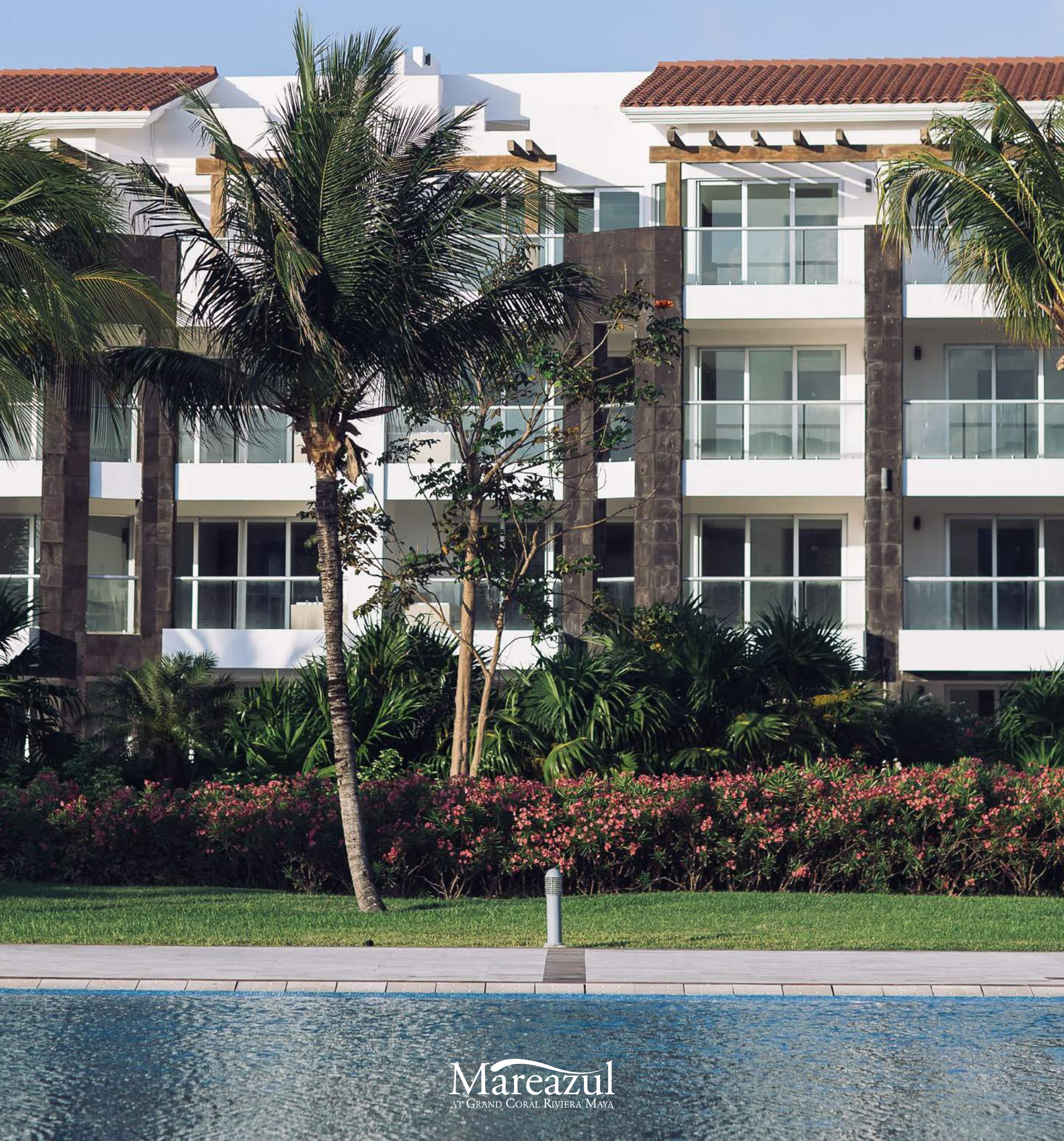



Residences

Apartment Type B

2 Bedrooms 3 Bathrooms

Total Area: 165.05 m² / 1,776.62 ft²

Apartment Type C

2 Bedrooms 3 Bathrooms

Total Area: 171.10 m² / 1,841.73 ft²

Apartment Type D

3 Bedrooms 4.5 Bathrooms

Total Area: 218.99 m² / 2,357.30 ft²

Apartment Type E

4 Bedrooms 5.5 Bathrooms

Total Area: 305.69 m² / 3,290.45 ft²

Tipo B

2 Bedrooms 3 Bathrooms

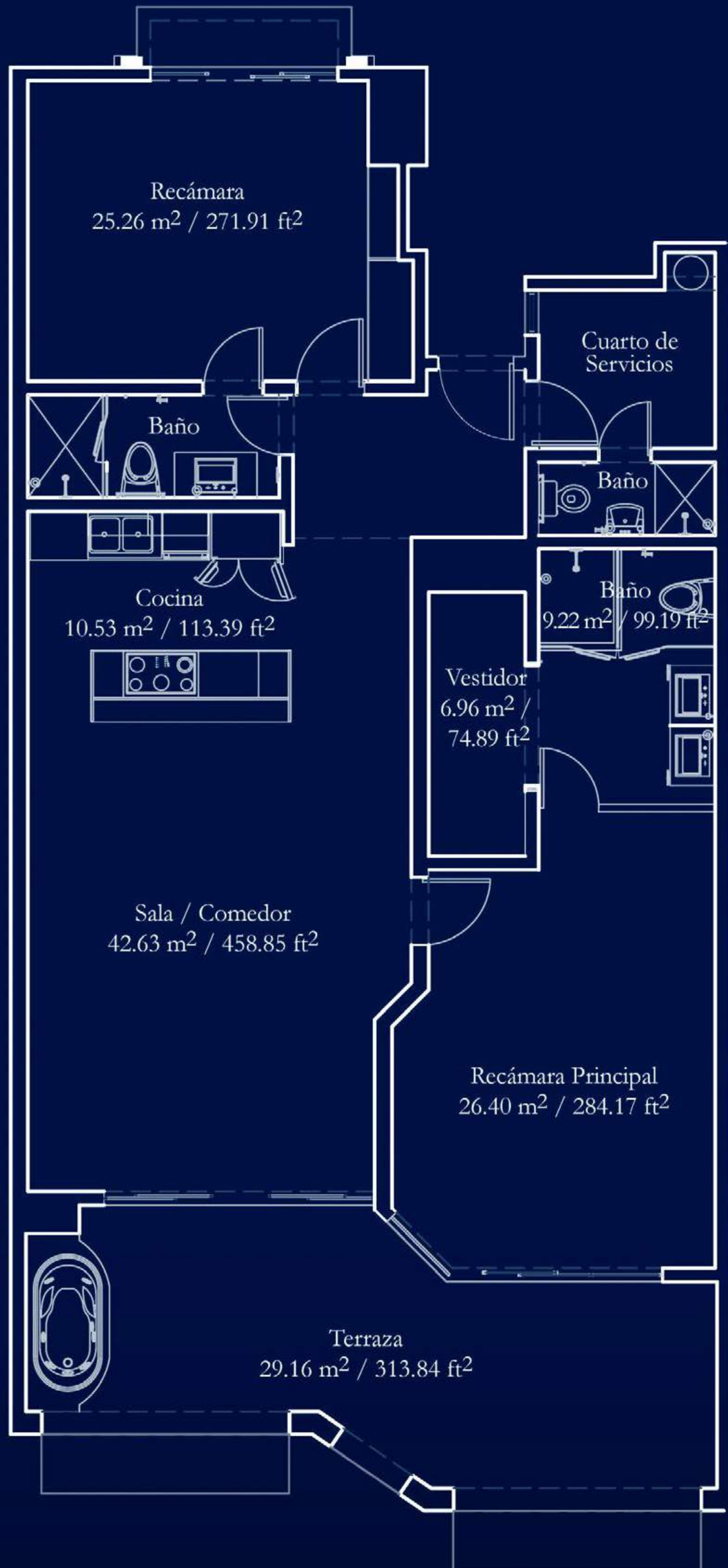

Total Area: 165.05 m² / 1,776.62 ft²

Tipo C

2 Bedrooms 3 Bathrooms

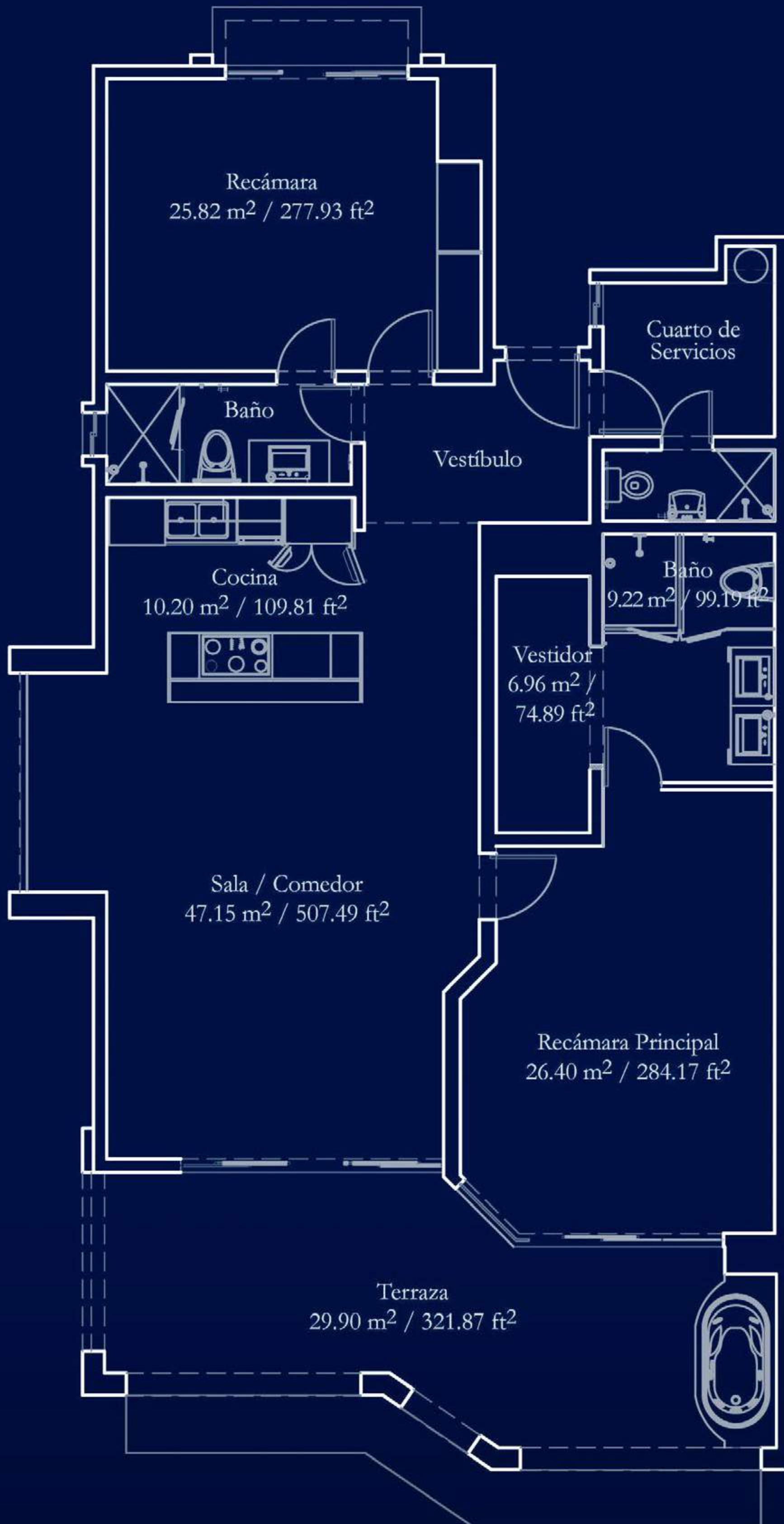

Total Area: 171.10 m² / 1,841.73 ft²

Tipo D

3 Bedrooms 4.5 Bathrooms

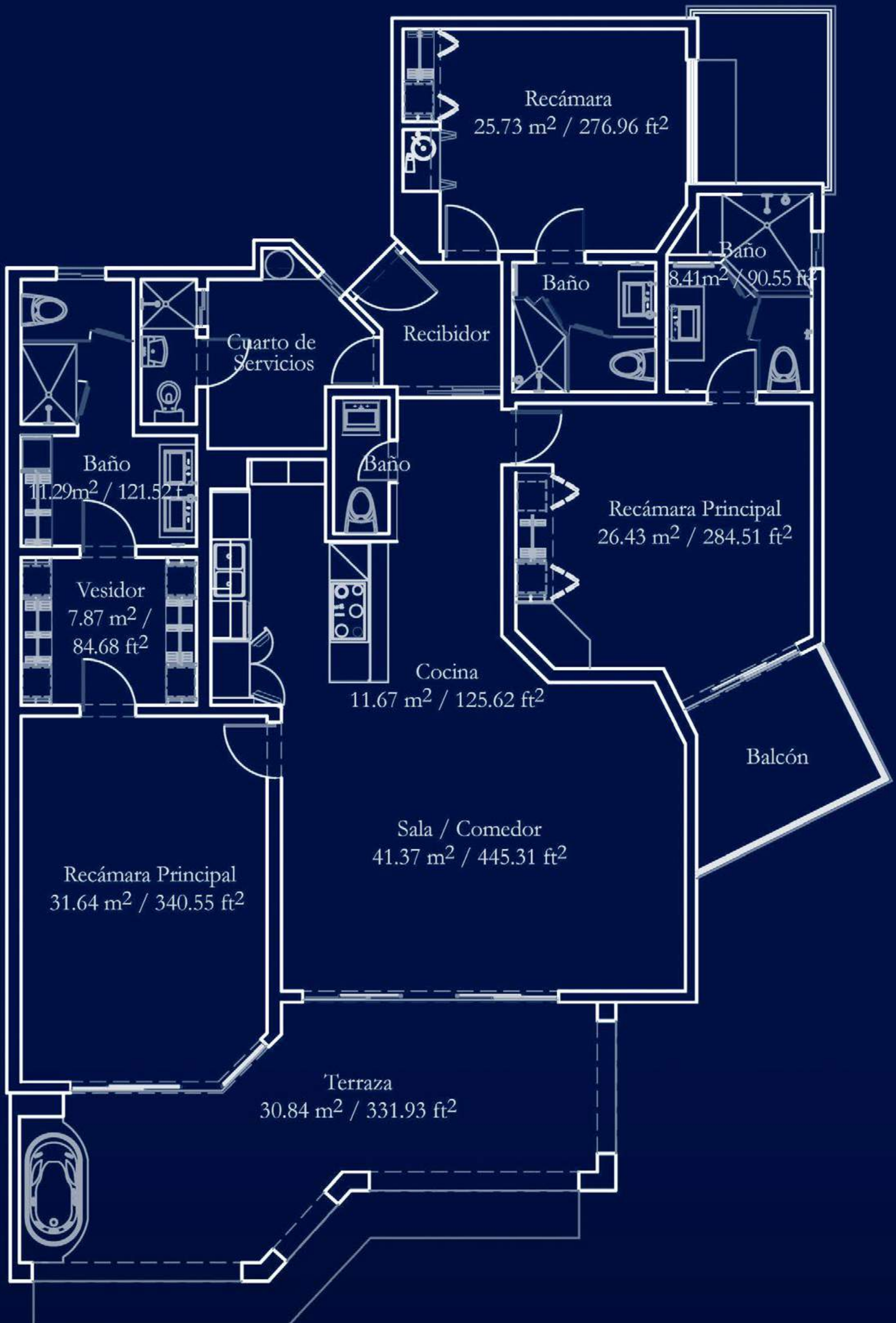

Total Area: 218.99 m² / 2,357.30 ft²

Tipo E

4 Bedrooms 5.5 Bathrooms

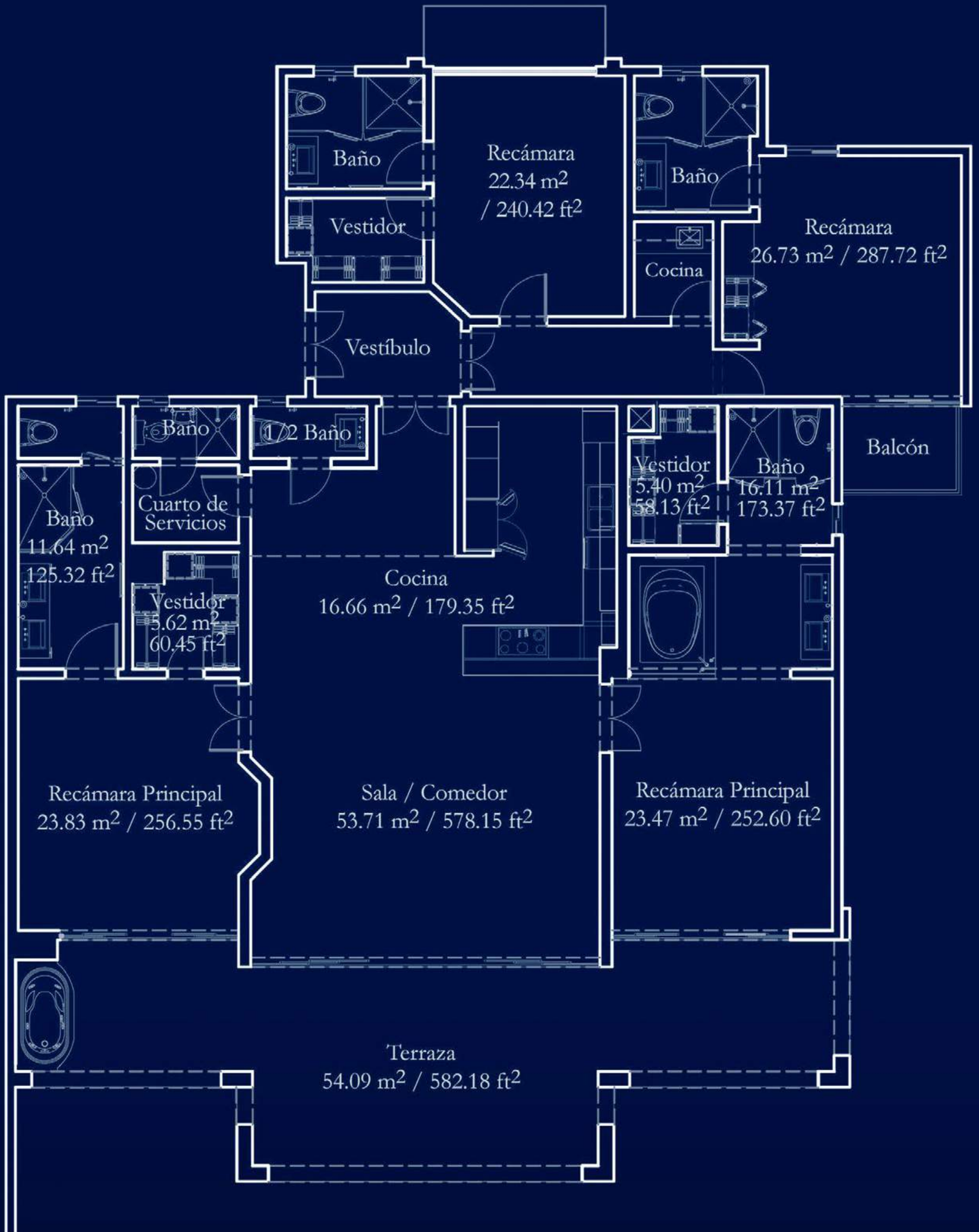

Total Area: 305.69 m² / 3,290.45 ft²

