

The background consists of several overlapping geometric shapes in shades of green and orange. A large, dark green shape is prominent on the left side, while a large, light orange shape is on the right. The text is centered over these shapes.

COSTA CARIBE

CONDOS EN TULÚM

Condos in Tulum



DÉJATE ENCANTAR EN COSTA CARIBE

Be enchanted by Costa Caribe

EL LUJO ES UBICACIÓN:

Luxury is location:



Costa Caribe se vive en Aldea Zamá

*(English) // Costa Caribe condos are located in Aldea Zamá, Tulum's
best development //*





TAN CERCA DEL PARAÍSO

So close to paradise

• • • •

TAN LEJOS DE LA RUTINA

So far from routine





COSTA
CARIBE

EL LUJO ES PAZ:

Luxury is to be at ease:



Relájate sin preocupaciones en la *Hamaca Garden* de Costa Caribe
(English) // Let yourself go by the soothing Hamaca Garden at Costa Caribe //





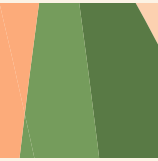

COSTA CARIBE:

Costa Caribe:



UNA CARICIA PENINSULAR

A peninsular caress





El corazón de Tulum late con una
nueva cadencia sofisticada gracias a los
condos Costa Caribe.

*(English) // The heart of Tulum beats with a new sophisticated
cadence due to the condos Costa Caribe.*

AMENIDADES

Amenities



JARDÍN ZEN Y DE YOGA

Zen and Yoga garden

4 ALBERCAS

4 Pools

JARDÍN CON HAMACAS

Hamaca garden

GIMNASIO

Gym

4 ELEVADORES

4 Elevators

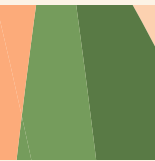



EL LUJO ES NATURALEZA:

Luxury is natural ambience:

• • • •

TERRAZAS VERDES ARMONIZAN
CON LA VISTA DE TULUM

*Green terraces harmonize with the
view of Tulum*

TERRAZAS EN ÁREAS VERDES

Terraces in green areas

ACCESO CONTROLADO 24 HRS

Controlled access 24 hrs

RECEPCIÓN

Lobby

CENTRO DE NEGOCIOS

Business Center

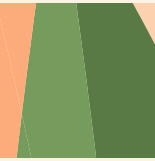









La mejor zona de Tulum para vivir en el paraíso.
Departamentos disponibles desde 50 m² — 160 m²

*(English) // The best area of Tulum to live in paradise.
Apartments available from 50 m² — 160 m²*



66 departamentos en 4 plantas,
1 y 2 recámaras.

*(English) // 66 condos on 4 floors,
1 and 2 bedrooms.*



1 Recámara / 1 Bedroom:

<i>Interior / Interior:</i>	<i>45.30 m² / 487.60 ft²</i>
<i>Terraza o Balcón / Terrace or Balcony:</i>	<i>11.45 m² / 123.24 ft²</i>
<i>Total / Total:</i>	<i>56.75 m² / 610.85 ft²</i>

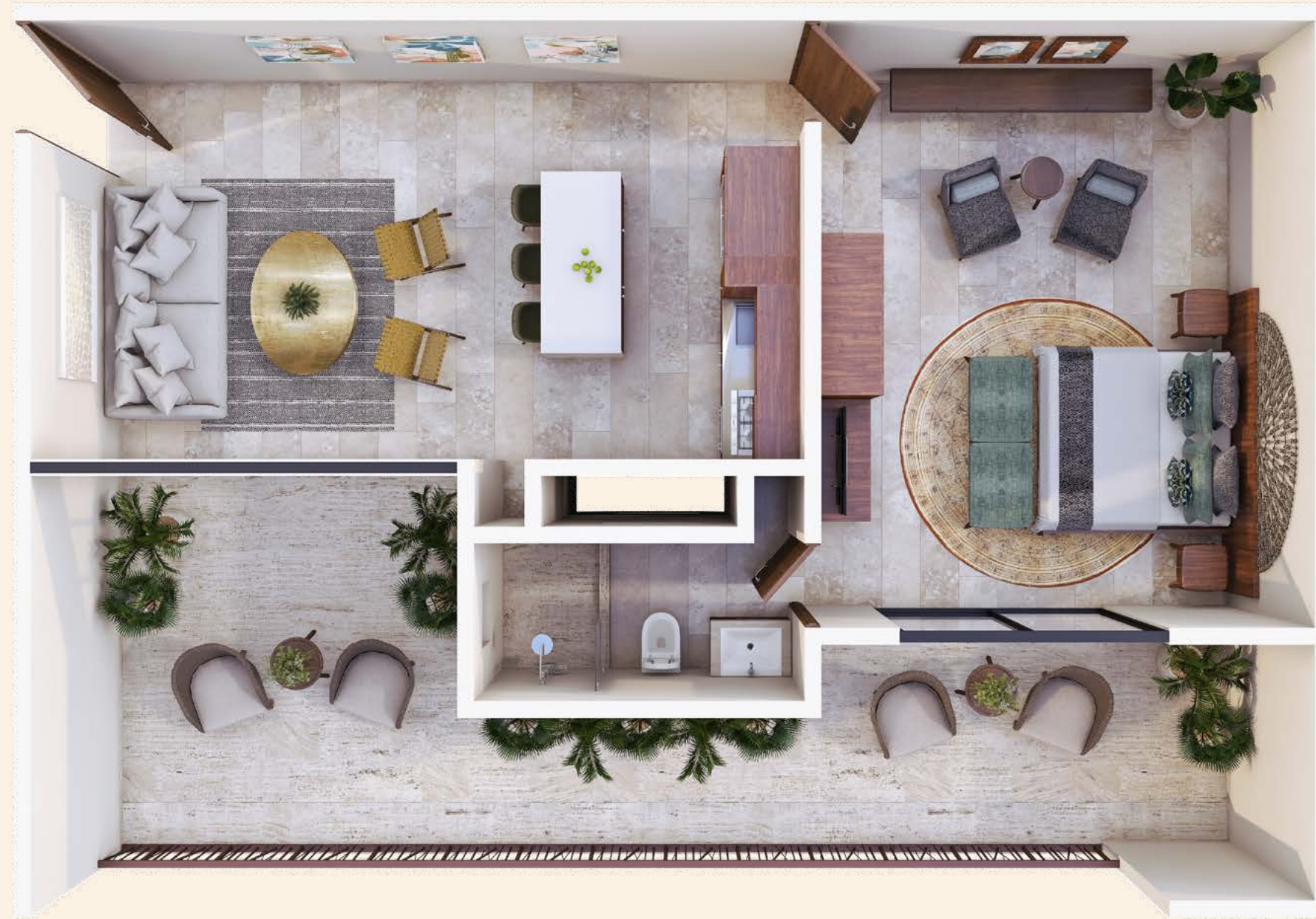

1 Recámara / 1 Bedroom:

<i>Interior / Interior:</i>	<i>61.57 m² / 662.73 ft²</i>
<i>Terraza o Balcón / Terrace or Balcony:</i>	<i>32.30 m² / 347.67 ft²</i>
<i>Total / Total:</i>	<i>93.87 m² / 1010.40 ft²</i>



1 Recámara / 1 Bedroom:

<i>Interior / Interior:</i>	<i>50.29 m² / 541.31 ft²</i>
<i>Terraza o Balcón / Terrace or Balcony:</i>	<i>9.50 m² / 102.25 ft²</i>
<i>Total / Total:</i>	<i>59.79 m² / 643.57 ft²</i>



1 Recámara / 1 Bedroom:

Interior / Interior: 51.40 m² / 553.27 ft²

Terraza o Balcón / Terrace or Balcony: 17.97 m² / 193.42 ft²

Total / Total: 69.37 m² / 746.69 ft²

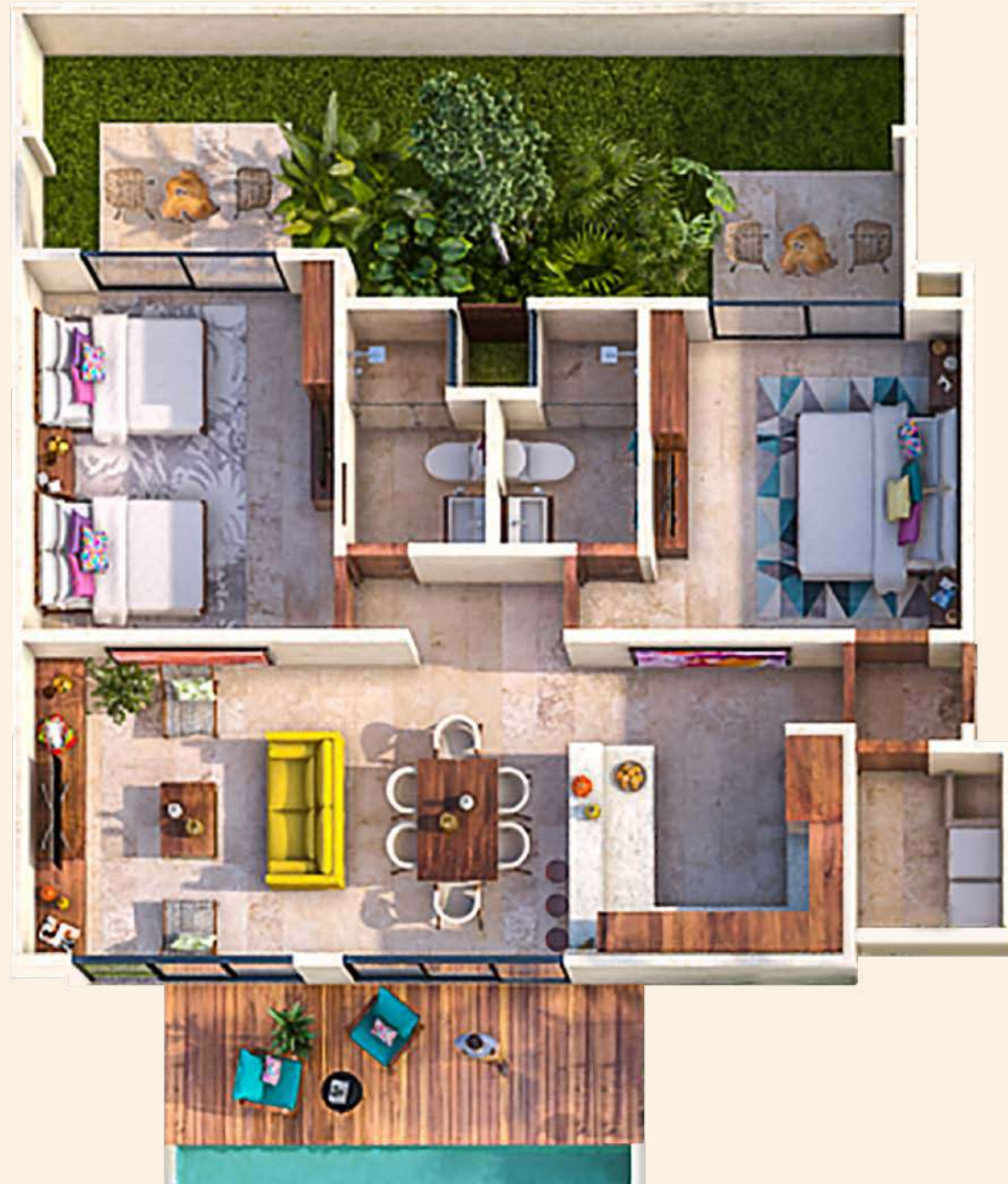

2 Recámaras / 2 Bedrooms:

<i>Interior / Interior:</i>	<i>100.07 m² / 1077.14 ft²</i>
<i>Terraza o Balcón / Terrace or Balcony:</i>	<i>16.90 m² / 181.91 ft²</i>
<i>Total / Total:</i>	<i>116.97 m² / 1259.05 ft²</i>



Penthouse / Penthouse:

<i>Interior / Interior:</i>	<i>99.84 m² / 1074.66 ft²</i>
<i>Terraza o Balcón / Terrace or Balcony:</i>	<i>50.45 m² / 543.03 ft²</i>
<i>Solarium / Solarium:</i>	<i>41.40 m² / 445.62 ft²</i>
<i>Total / Total:</i>	<i>191.69 m² / 2063.33 ft²</i>



30

Penthouse / Penthouse:

<i>Interior / Interior:</i>	<i>99.93 m² / 1075.63 ft²</i>
<i>Terraza o Balcón / Terrace or Balcony:</i>	<i>11.70 m² / 125.93 ft²</i>
<i>Solarium / Solarium:</i>	<i>42.94 m² / 462.20 ft²</i>
<i>Total / Total:</i>	<i>154.57 m² / 1663.77 ft²</i>



Penthouse / Penthouse:

<i>Interior / Interior:</i>	<i>98.95 m² / 1065.08 ft²</i>
<i>Terraza o Balcón / Terrace or Balcony:</i>	<i>11.70 m² / 125.93 ft²</i>
<i>Solarium / Solarium:</i>	<i>42.94 m² / 462.20 ft²</i>
<i>Total / Total:</i>	<i>153.59 m² / 1653.22 ft²</i>











Desde aquí, en el lujoso desarrollo Aldea Zama
que se ubica en pleno centro de la villa pesquera.

*(English) // From here, at the luxurious Aldea Zama
development in the center of the fishing village //*

UBICACIÓN:

Location:

Zona residencial de Aldea Zamá a 1.5 km
de la Zona Hotelera.
Tulum, Q. Roo, México.

—
*Residential area of Aldea Zama 1.5 km from
the Hotel Zone.
Tulum, Q. Roo, Mexico.*



TAN CERCA DE LA PLAYA,

So close to the beach,

• • • •

TAN LEJOS DE LA RUTINA.

So far from the routine.



CONDOS:

Desde \$ 145, 400USD.

Entrega Verano 2021.

From \$ 145, 400 USD

Delivery Summer 2021.