



C

H

V

Y

REFLECTION

LOFTS

TULUM

A piece of art is nature in itself, ignite a spark of inspiration in every corner of our souls. We are here to stretch humanity into new possibilities, to invite to expand crave their own path an inspire others to do the same and deeply understand the wisdom of your body.

We are here to learn through our own experiences and release us from attachments.

We dream to offer you a beautiful space, to reflect your soul and learn that you can be financially resourced for doing what you love.

# PROJECT PHYLOSOPHY



C H Y



**GREEN BUILDING**  
Sophisticated and secure space

WHERE THE EXTERIOR &  
THE INTERIOR MERGE  
AND RECOMBINE.

*We Build Unique Experiences  
in our Developments.*

Inspired by the Maraya Concert Hall in AlUla, Saudi Arabia, by the winner of the A + Awards, in the Architecture + category.

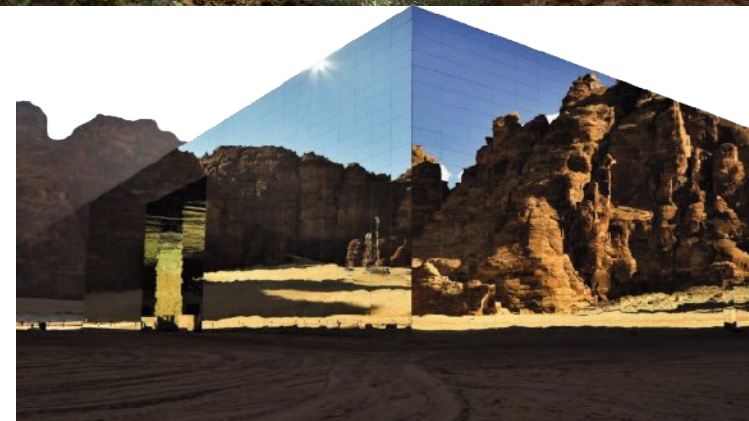

# PREMIUM LOCATION

Truly privileged location in Tulum, right next to the sanctuary Holistika a total stress-free zone in the middle of the jungle, a place for healing, exploring and reflecting. This community offers intimacy and rapid access to a variety of services and immediate access to the hotel zone of Tulum.

HOLISTIKA

CHAY

TULUM  
TOWN

CARRETERA FEDERAL  
HIGHWAY to CANCUN

ALDEA  
ZAMA

ARQUEOLOGIC  
▲ ZONE

MAR  
CARIBE

- CANCÚN
- PLAYA DEL CÁRMEN
- COZUMEL

● TULÚM



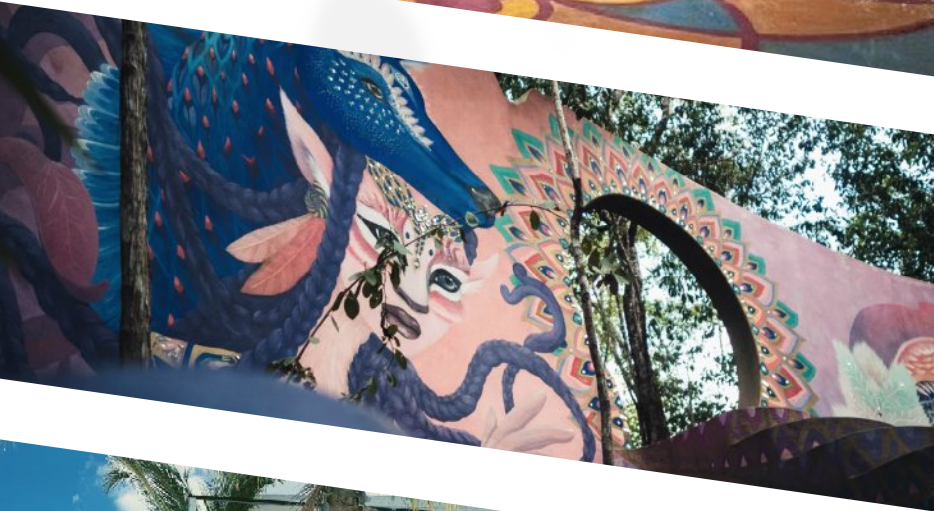

## ONLY STEPS FROM HOLISTIKA

---

UNIQUE ATTRACTIONS  
NEXT TO YOU

The Dome  
Surrealistic Spaces

The Shalas  
Best Yoga Practice

Sculpture Gardens  
& Art Walk

Conscious Eating Restaurant

Gypsea Market  
& Art Walk

22

REFLECTION  
LOFTS

100% FURNISHED



UNIQUELY  
PEACEFUL,

*Beautifully restfull*

The most beautiful things in the world  
you can see them, even touch them,  
but you must **feel** them.



LIVING ROOM  
KITCHEN  
KING SIZE BED  
& BATHROOM

USING FIRST CLASS BUILDING  
MATERIALS AND LUXURY FINISHES.  
THE LOFTS WILL BE DELIVERED  
FULLY FURNISHED AND  
EQUIPPED WITH TURNKEY

C

H



Y





# LOFT LAYOUTS

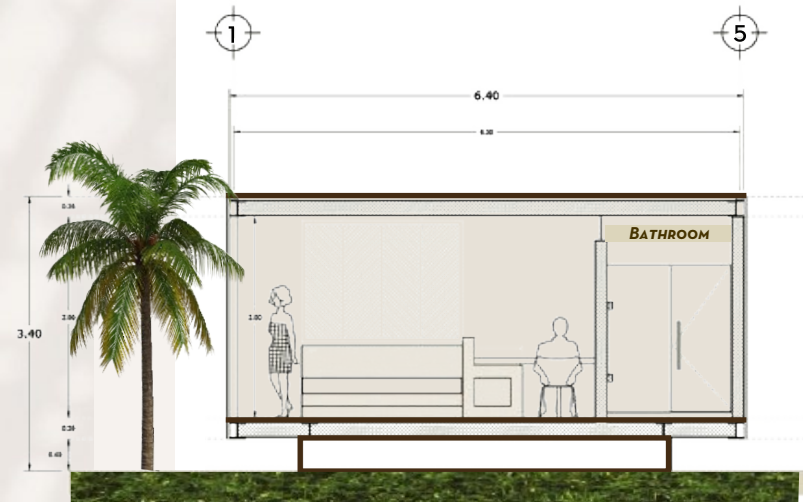
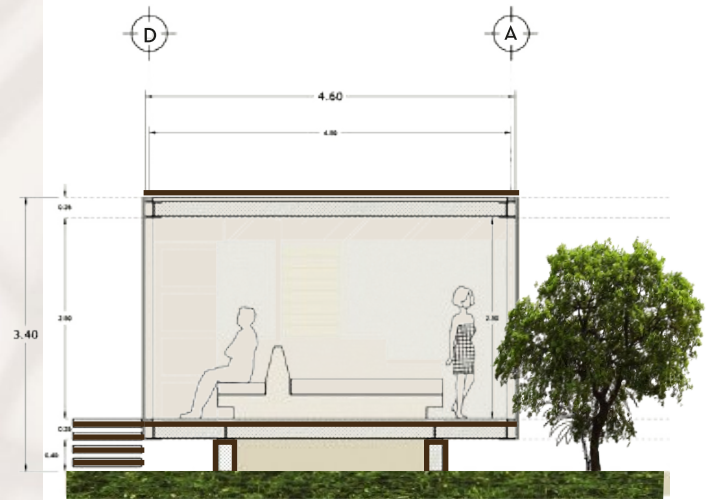

# AMENITIES



GREEN AREAS

NATURE FRIENDLY

EXCLUSIVE  
MEMBERSHIPS

ORGANIC MARKET  
POOL WITH CAULDRON  
YOGA & MEDITATION AREA  
LOUNGE AREA  
LAUNDRY  
GYM  
BAR  
RECEPTION  
BEACH CLUB  
OUTDOOR PARKING  
24/7 SECURITY

EXPAND YOUR BUSINESS

BECOME A HOST IN TULUM

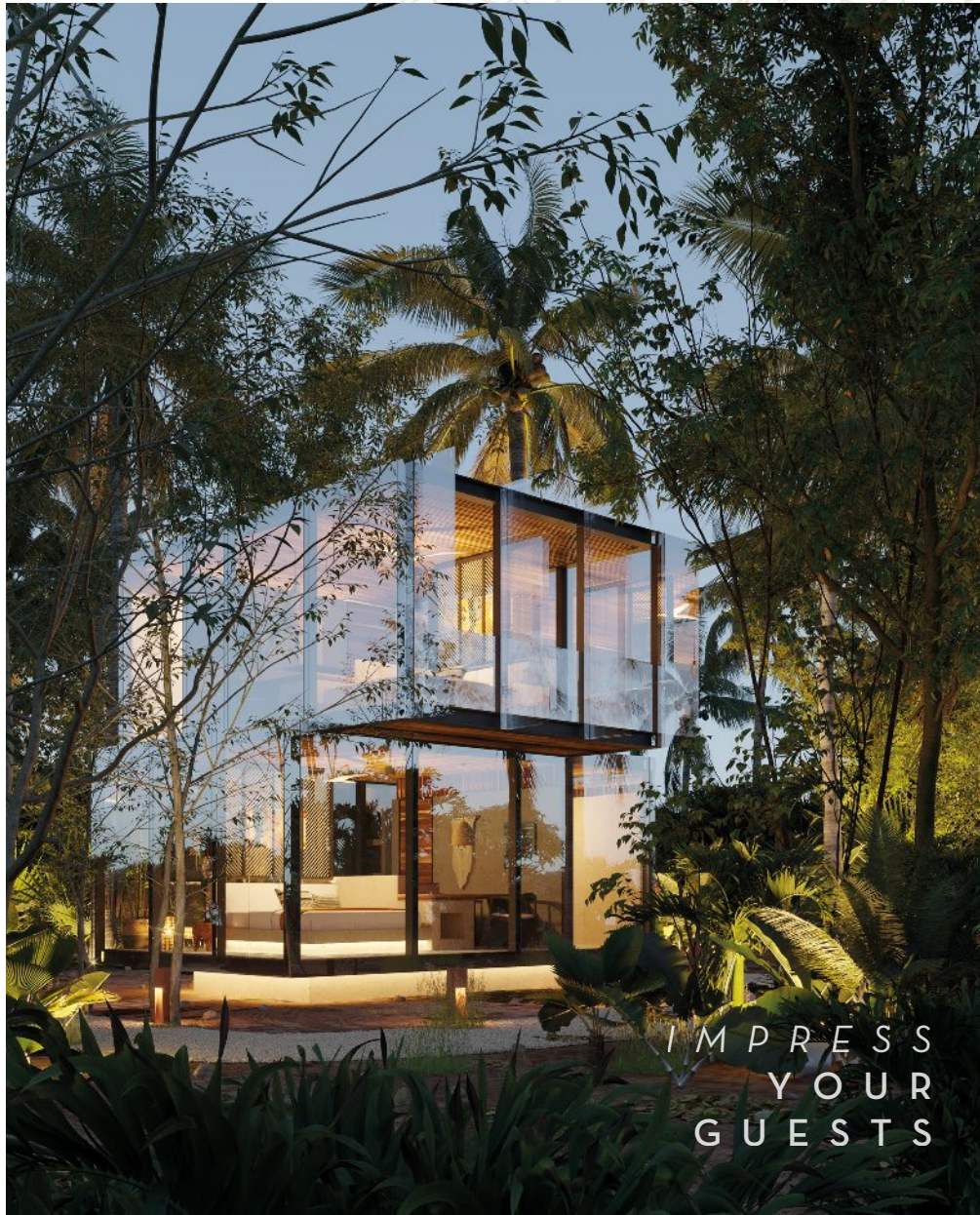

IMPRESS  
YOUR  
GUESTS

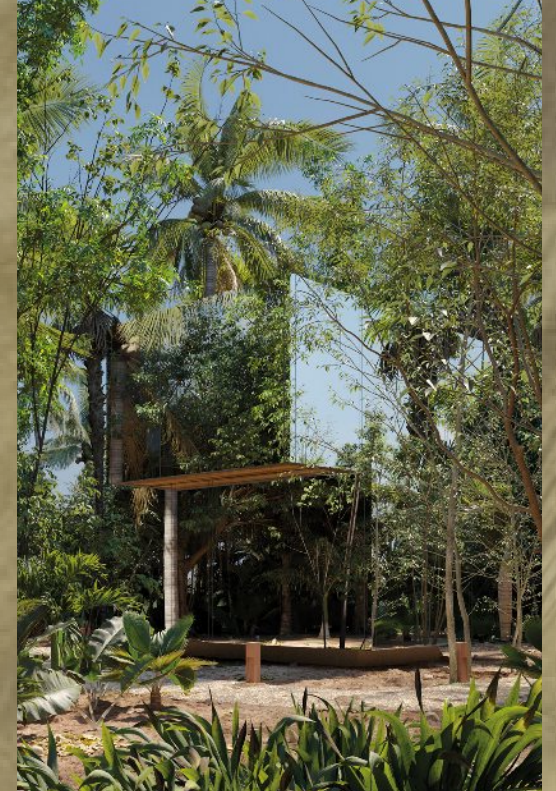

IDEAL  
INVESTMENT  
PROPERTY

UNIQUE ARCHITECTURAL  
EXPERIENCES

CREATE MORE VALUE  
TO YOUR CUSTOMERS

GENERATING MORE PROFIT  
TO OUR INVESTORS

GREATER OCCUPANCY  
RATES AT HIGHER PRICES

# REDUCING IMPACT

## LOW DENSITY

With 22 lofts on a surface of 20,430 SQFT, we have preserved 50% of green areas. The idea is to have spaces to be inside an inner place with no distractions.

## PRIVACY

Each Cube is surrounded by jungle.

## LOWER MAINTENANCE COSTS

More space means more trees. Their shade will keep your Loft cool and your energy cost low.

## ENERGY EFFICIENCY PRACTICES

Strategical green spaces around each loft, solar panels in common areas and the use of LED lights in all our spaces are all examples of how we can prevent excessive energy costs and lower the environmental impact.

PRESERVING 50% OF GREEN  
AREAS TO ACHIEVE PRIVACY  
IN EACH UNIT

SOLAR PANELS IN  
COMMON AREAS



EcoGreen  
Optimized environment solutions

# EXCLUSIVE MEMBERSHIPS

JOIN OUR SAILING CLUB IN DIFFERENT PARTS OF THE WORLD

FROM  
**\$ 4 5 0 0** USD

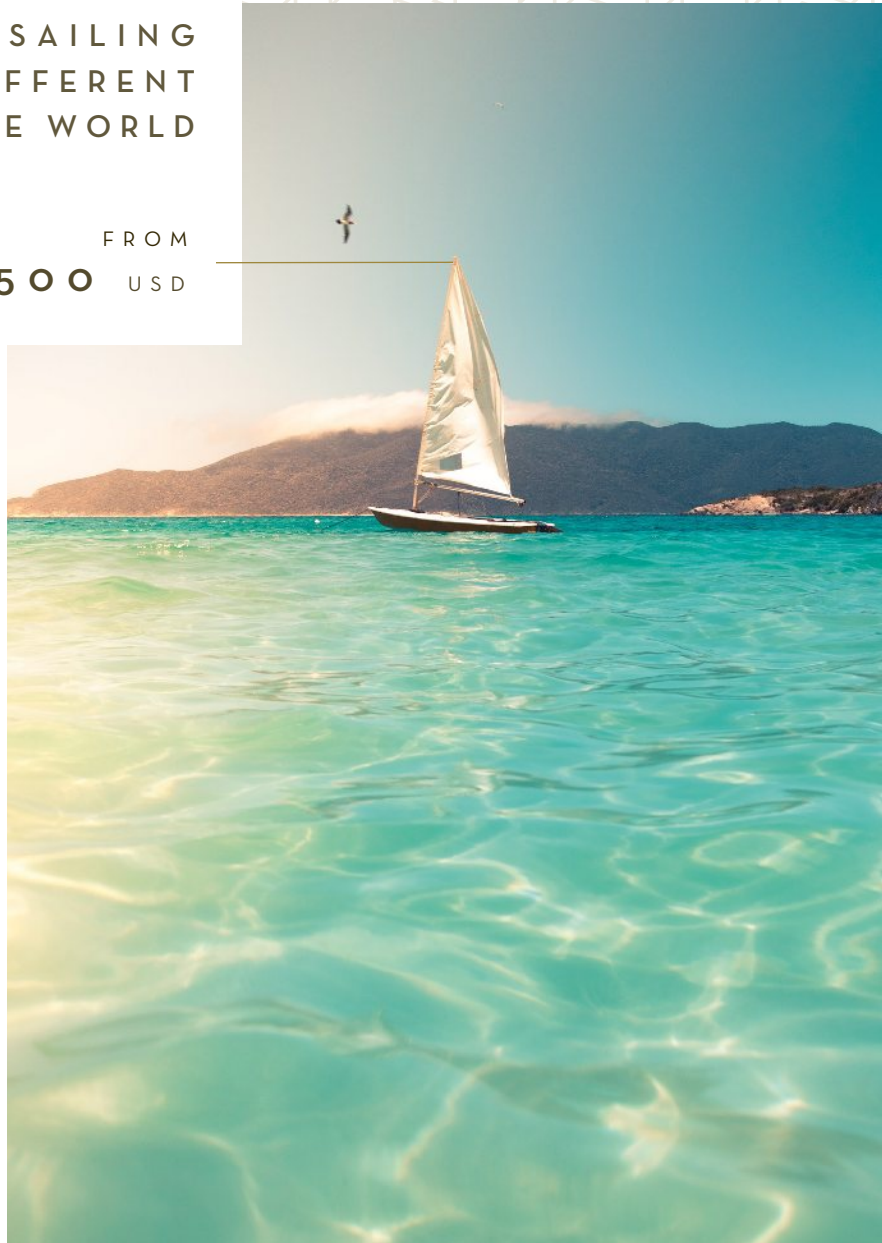

**Hästens**   
since 1852

BE AWAKE FOR THE FIRST TIME IN YOUR LIFE WITH...

FROM  
**\$ 8 0 0 0** USD

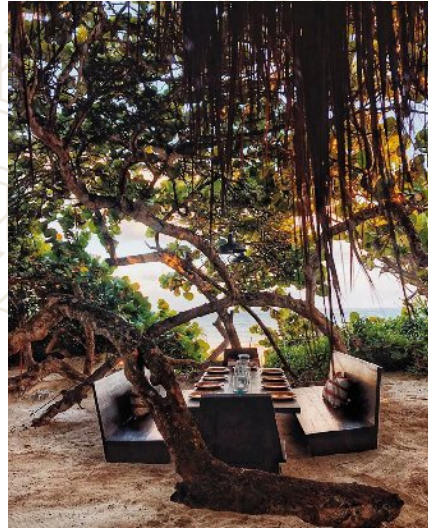
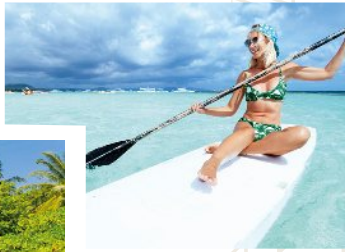

We have selected a healthy and inspiring lifestyle. This is where you come to care of yourself and your loved ones.

Right outside the comfort of your loft you find lots of amenities, with all the facilities to unwind from the demanding city life.

- REST
- NURTURE
- MEDITATE
- EXERCISE
- READ
- INTERACT

*Love your life*

A modern, multi-story building with a glass and wood facade is nestled within a dense tropical forest. The building features large glass windows and balconies, reflecting the surrounding greenery. The architecture is contemporary and blends with the natural environment. The scene is captured in bright daylight, with sunlight filtering through the trees.

THINKING  
ABOUT INVESTING?

YOU HAVE THE ANSWER, WITH  
CHAY REFLECTION LOFTS