

SABELLA

— T U L U M —

Why Tulum?

Tulum gathers the magic of Caribbean and Jungle lush landscapes with the majesty of the Mayan Culture and together they become into an important experience connecting mind, body and soul. Tulum mixes styles, ideas, nature, people and new environments that leave a sparkle in the mind of those who visit.

SABELLA





Being one with nature

Located in the “Holistika” neighborhood, a place where art, wellness and consciousness are the main guidelines and connects with those who have the shared mindset to take care of their new home. When you live in Sabella you feel relaxed and you connect with your thoughts.

SABELLA

Sabella

Is a 4 independent houses development at Holistika's Neighborhood, one of Tulum's favorite wellness recreational place where you are able to enjoy and connect with nature in a unique way. Sabella's design embraces mayan traditional elements and mixes them with contemporary architecture for a more dynamic and harmonious way of living.

SABELLA

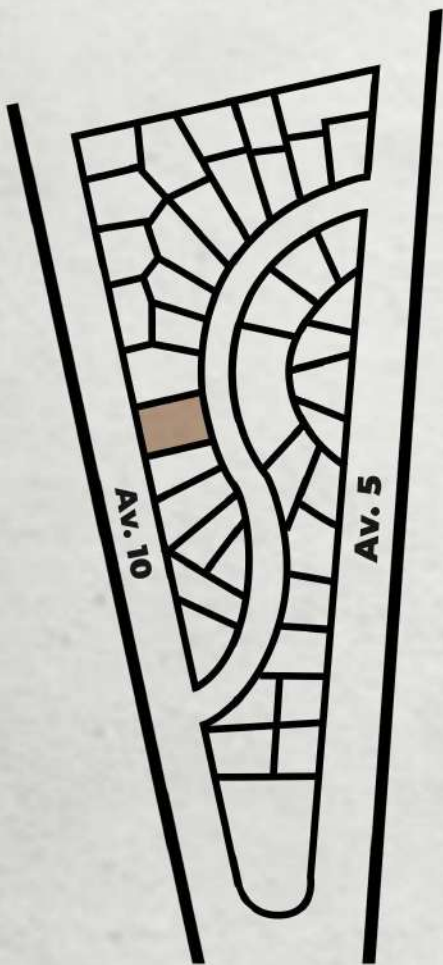

Mza 923, Lt. 002-20
Región 12
Tulum, Q.Roo



LOCATION



Luxury Villas

SABELLA



The Design

LS-LAB

Mexico, Perú, United States, Saudi Arabia

Formed by:

Ruben Segovia :

Architect (Tec de Monterrey Campus Monterrey)
Masters Degree in Architectural Design (Harvard Graduate
School of Design)

Delia Leal

Architect (Tec de Monterrey Campus Monterrey)
Masters Degree on Arts Investigation (Universidad Autónoma
de Nuevo León - UANL)

Actually co founder and co director of the design and
research office of LS-LAB

SABELLA

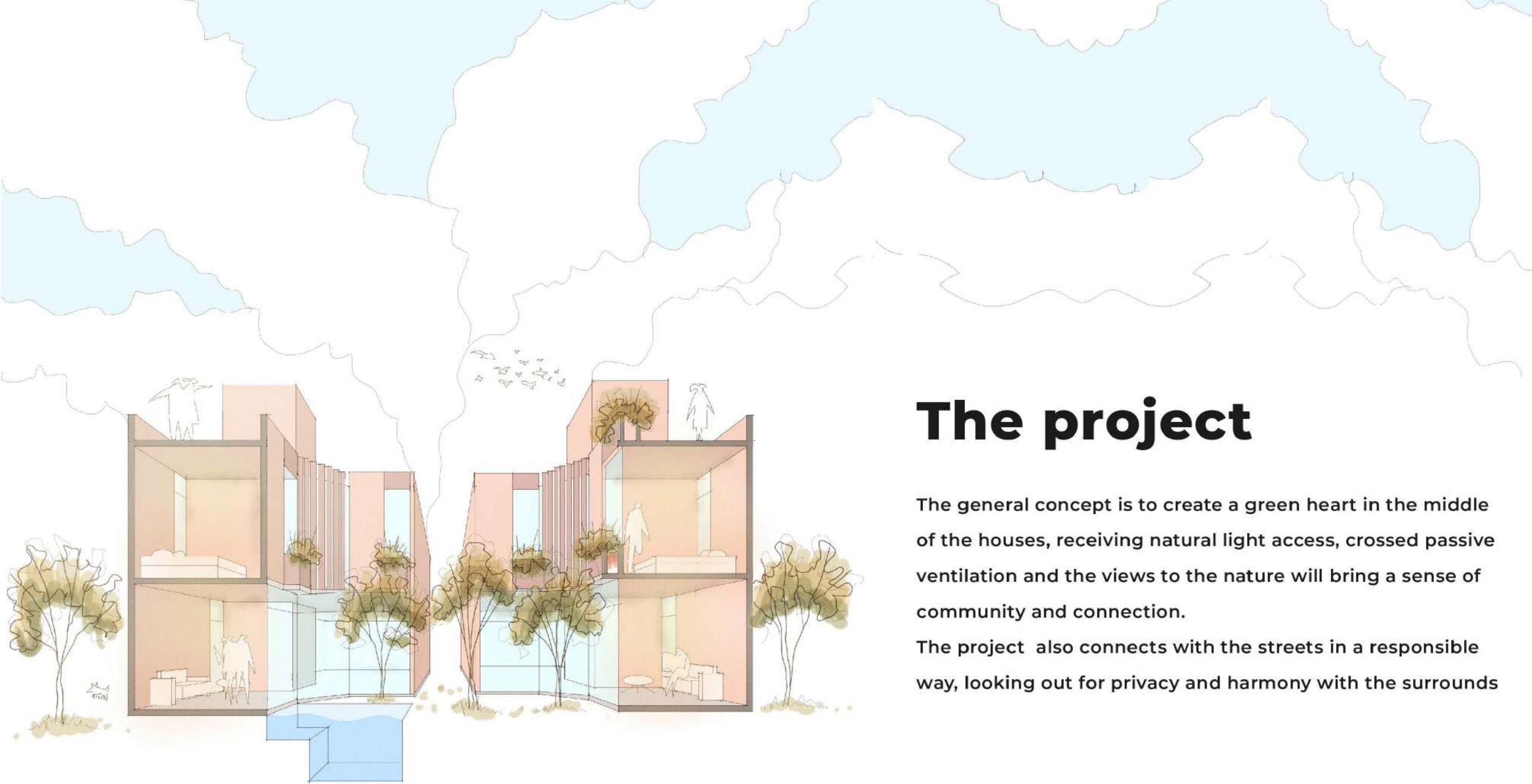

The project

The general concept is to create a green heart in the middle of the houses, receiving natural light access, crossed passive ventilation and the views to the nature will bring a sense of community and connection.

The project also connects with the streets in a responsible way, looking out for privacy and harmony with the surrounds

SABELLA



SABELLA

Luxury Villas

The place where

SABELLA

**is found has an essence
and own voice.**

The landscape is the main connector between the in and out spaces, brings the possibility of passive climatization, water absorption and shadow placements. The area has majestic trees like Yaxnic and chacá, which we conserve in order to respect nature.

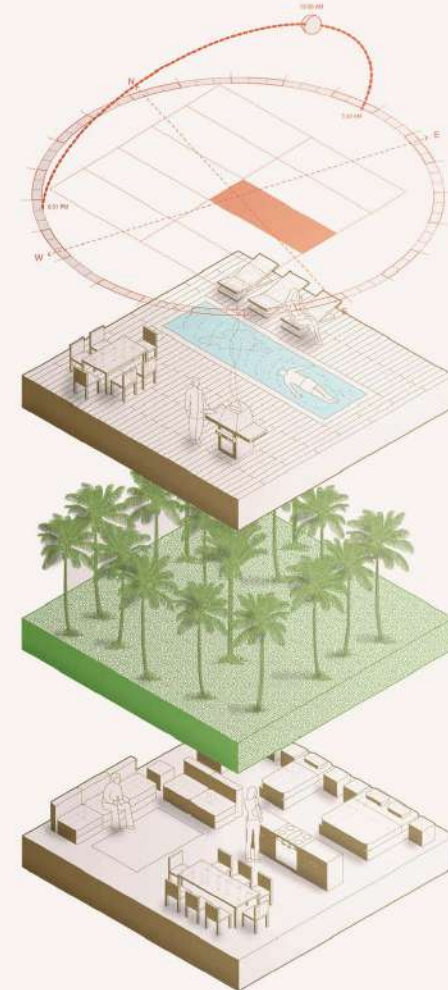



Luxury Villas

SABELLA

ROOFTOP



LUXURY VILLAS

CASA 1 - 2 AIRA

Construcción interior: 115.20m²

Construcción exterior: 15.23m²

PLANTA BAJA

2 Cajones de Estacionamiento

Sala / Comedor

Cocina

Patio

Área de servicio

½ Baño

PLANTA ALTA

2 Recámaras

C/ Baño Completo c/u

C/ Clóset c/u

ROOFTOP

Espacio de 29 m².

Con Piscina de 4.16 m².

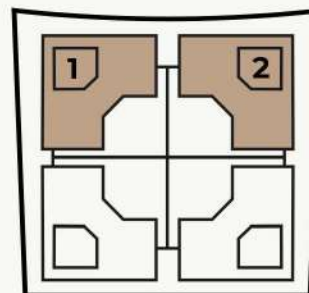

CASA 3 - 4 TERRA

Construcción interior: 115.20m²

Construcción exterior: 15.23m²

PLANTA BAJA

2 Cajones de Estacionamiento

Sala / Comedor

Cocina

Patio

Área de servicio

½ Baño

Piscina

PLANTA ALTA

2 Recámaras

C/ Baño Completo c/u

C/ Clóset c/u

ROOFTOP

48.61 m².

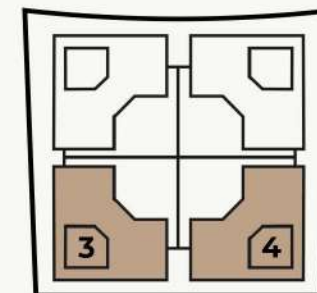



Luxury Villas

SABELLA

GROUND FLOOR

HOUSE 1 - 2 AIRA

- 2 parking lots
- Living Room / Dining Room
- Kitchen
- Patio
- Service Area
- Half Bathroom

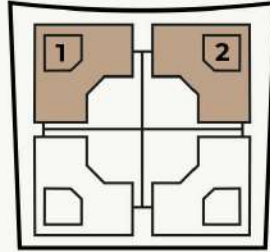

HOUSE 3 - 4 TERRA

- 2 Parking Lots
- Living Room / Dining Room
- Kitchen
- Patio
- Service Area
- Half Bathroom
- Pool

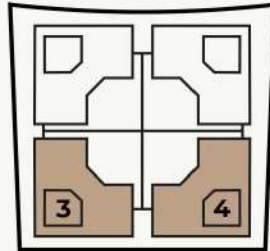

Luxury Villas



Luxury Villas

SABELLA

Las imágenes son con fines ilustrativos, los acabados y materiales pueden variar a elección del cliente. Comprueba los materiales a elegir en nuestro moodboard.

FIRST LEVEL

HOUSE 1 - 2 AIRA

2 Bedrooms
Full Bathrooms in each bedroom
Closet in each bedroom

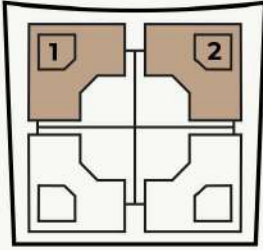

HOUSE 3 - 4 TERRA

2 Bedrooms
Full Bathrooms in each bedroom
Closet in each bedroom

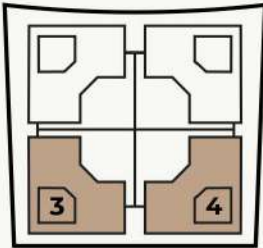



Luxury Villas

SABELLA

Las imágenes son con fines ilustrativos, los acabados y materiales pueden variar a elección del cliente. Comprueba los materiales a elegir en nuestro moodboard.

ROOFTOP

HOUSE 1 - 2 AIRA

Area: 29 m2.
Pool: 4.16 m2.

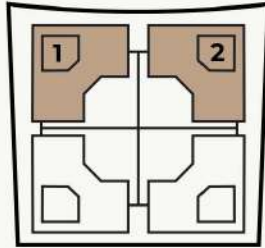

HOUSE 3 - 4 TERRA

Area: 48.61 m2.

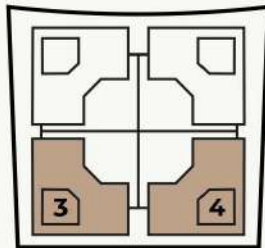



SABELLA

Luxury Villas



Luxury Villas



Equip your home with:

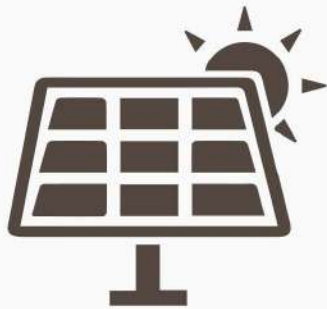

**SOLAR
PANELS**



**INTELLIGENT
LOCKS**



GARAGE