

COMING SOON

*Amira  
District  
Phase 2*

Amira  
District

*It's Back*

THE ONLY **ONE** NEAR THE BEACH



Amira  
District

# A UNIQUE AND SUSTAINABLE PROJECT

*in harmony with nature*

Amira District stands as an organic architectural marvel, seamlessly integrated with nature. This situates it among the most captivating real estate ventures in the exclusive expanse of the Mexican Caribbean. Its distinctiveness lies in its unwavering commitment to core values, alongside a forward-thinking perspective aimed at seamlessly weaving them into Tulum's way of life and urban design.



CARR. CANCUN - TULUM

ZONA ARQUEOLOGICA TULUM

TULUM CENTRO

CHEDRAUI TULUM

PARQUE NACIONAL TULUM

PLAYA SANTA FE

PLAYA PARAÍSO

ALDEA ZAMA

AV. COBÁ

LA VELETA

PLAYA LAS PALMAS

LA COSTERA

Amira District

Amira District

Prime LOCATION

YOU'LL FIND YOURSELF

*just 280m away from the beach*

Amira District enjoys an impeccable location – it's the nearest development to Tulum's pristine beach while being embraced by the captivating allure of the Mayan jungle.

Amira  
District



# CONDOS | FLOOR PLANS

Each condominium seeks to emulate the balance between mind and soul, based on biomimicry. This seeks to offer the inhabitants a unique space, which serves as an escape from everyday life and allows maximum relaxation in harmony.

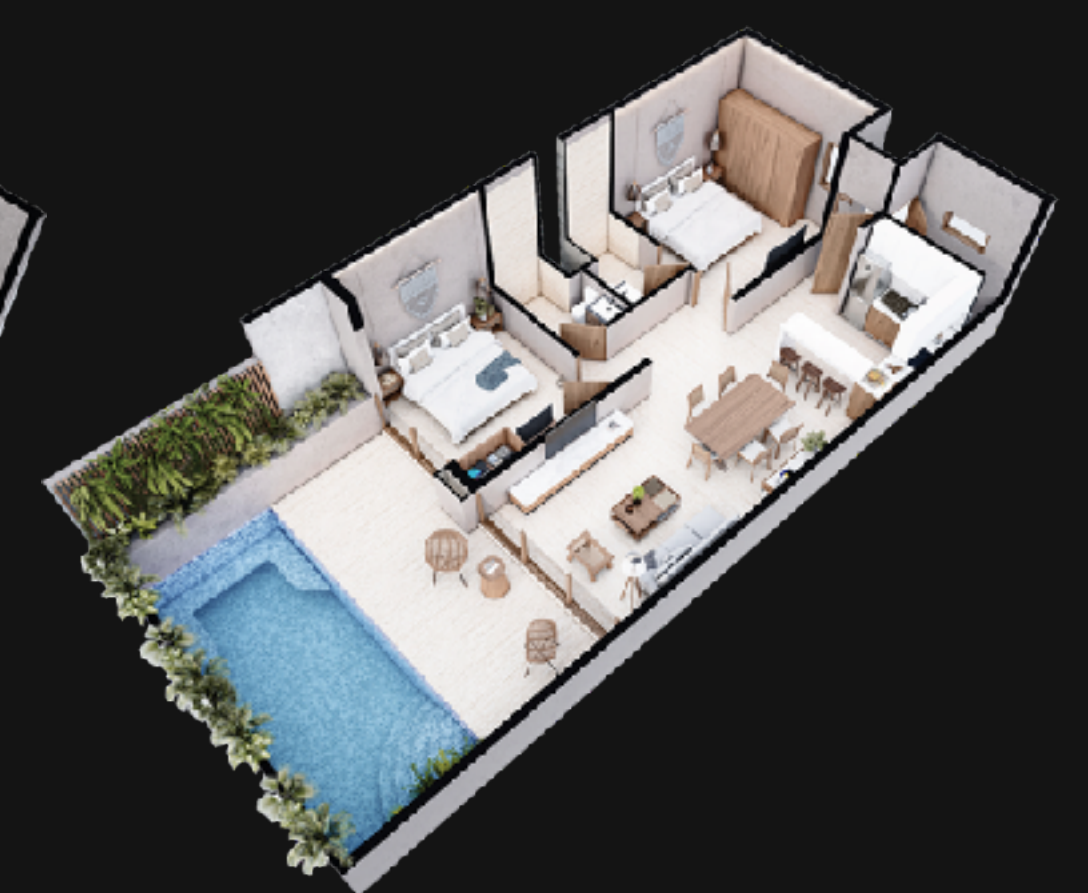

## Studio

Interior: 37.20 m<sup>2</sup>  
 Terraza: 5.50 m<sup>2</sup>  
 Total: 42.70

## 1 Bedroom

Interior: 40.20 m<sup>2</sup>  
 Terraza: 5.50 m<sup>2</sup>  
 Total: 45.75

## 1 Bedroom Garden

Interior: 40.20 m<sup>2</sup>  
 Terraza: 17.55 m<sup>2</sup>  
 Total: 57.75

## 2 Bedrooms

Interior: 80.90 m<sup>2</sup>  
 Terraza: 15.34 m<sup>2</sup>  
 Total: 99.24 m<sup>2</sup>

## 2 Bedrooms Garden

Interior: 80.90 m<sup>2</sup>  
 Terraza: 41.37 m<sup>2</sup>  
 Total: 122.27 m<sup>2</sup>



Amira  
District



# PH | FLOOR PLAN

Step into your future experience, where an unparalleled panoramic view of Tulum awaits you. The Amira District Penthouse is the perfect place for those looking to immerse themselves in a space imbued with elegance and refinement.



## PH | 3 Bedrooms

Interior: 152.13 m<sup>2</sup>

Terraza: 57.07 m<sup>2</sup>

Total: 209.2 m<sup>2</sup>

Amira  
District



# AMENITIES

- Outdoor connected pools with an artificial river
- Rooftop pools with connecting bridges
- Exclusive Beach Club
- Jungle gardens
- Hammock area
- Bonfire areas
- Multipurpose pavilions
- Kids Club (nursery)
- Gym / Yoga
- Spa
- Bar
- Restaurant
- Laundry
- 24/7 Security



---

**RESERVE YOUR  
SPOT \$5,000 USD**

---

**BE ONE OF THE FIRS TO SELECT YOUR  
PREFERRED UNIT!\***

\*The selection of units will be honored according to the order in which the deposits are received.



Amira  
District

Amira  
District  
Phase 2