

# PAYMENT SCHEMES

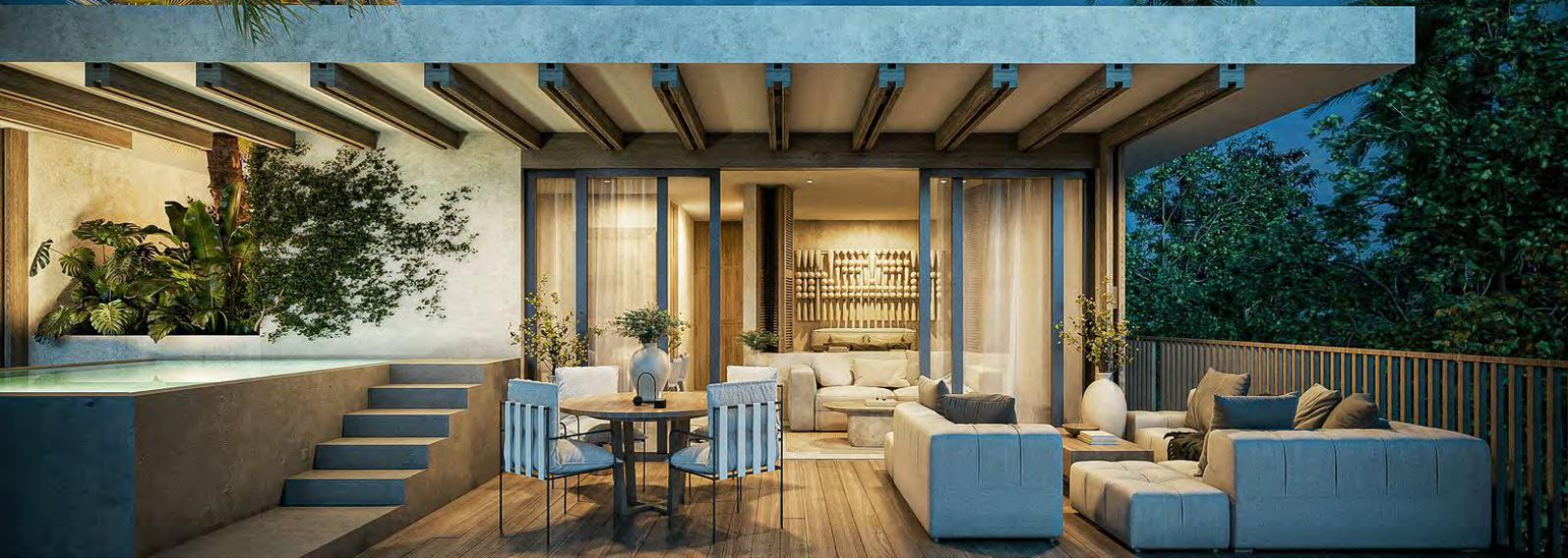

30% down payment  
30% during construction  
40% upon delivery

- 2%

40% down payment  
20% during construction  
40% upon delivery

- 3%

50% down payment  
10% during construction  
40% upon delivery

- 4%

60% down payment  
40% against delivery

- 5%

70% down payment  
30% against delivery

- 7%

80% down payment  
20% against delivery

- 8%

90% down payment  
10% against delivery

- 9%

100% down payment

- 10%