



ÁRVORE
LUXURY EXPERIENCE



ÁRVORE
LUXURY EXPERIENCE

-CANCÚN-

YOUR STYLE IS OUR
INSPIRATION







WE SOW A NEW EXPERIENCE

Relax and enjoy a quiet and adventurous **life surrounded by first class services.** The ideal paradise to enjoy the sunset and enjoy beautiful beaches and parks.

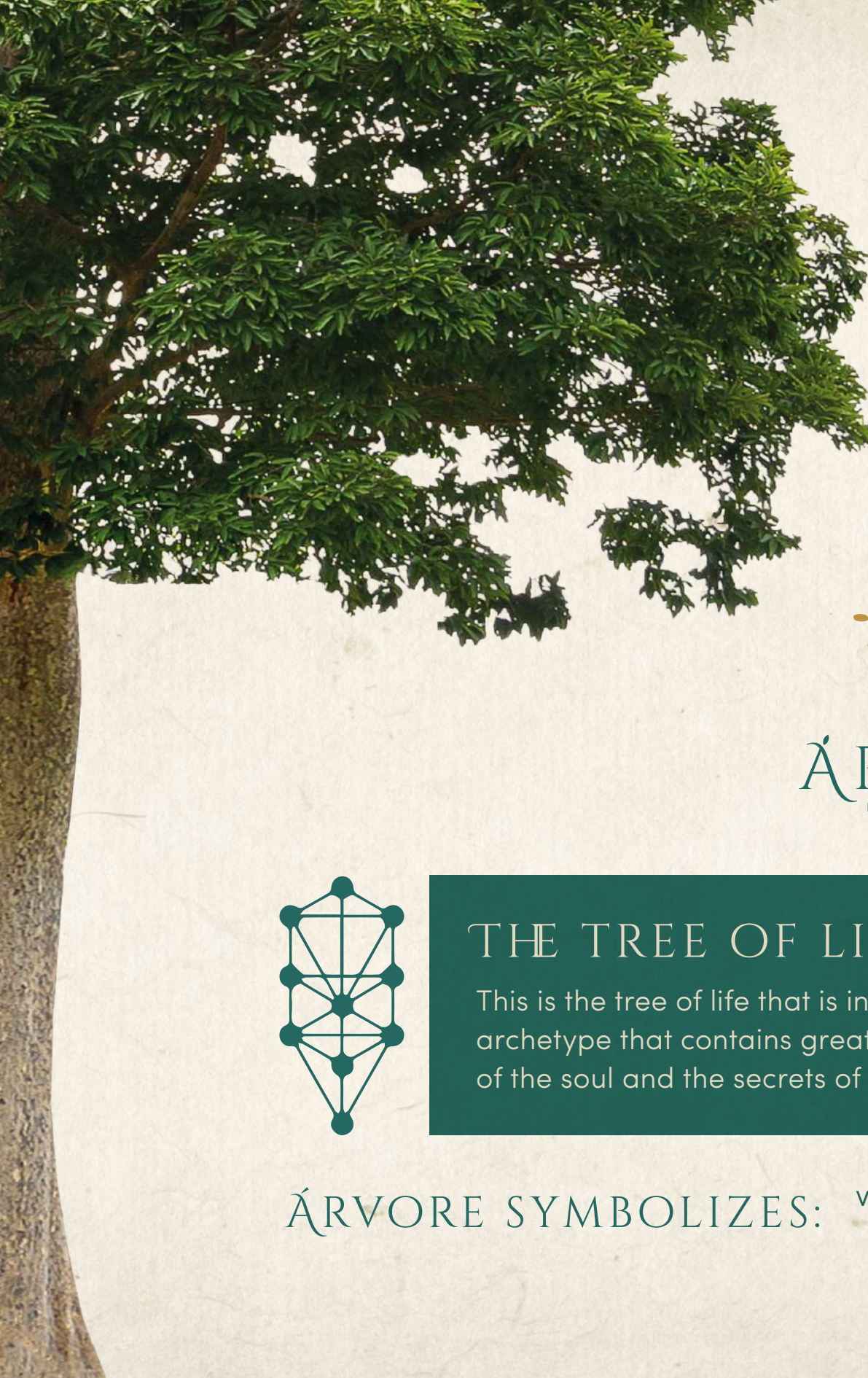

ÁRVORE
LUXURY EXPERIENCE



THE TREE OF LIFE

This is the tree of life that is in the center of paradise. It is an archetype that contains great spiritual power. It is the world of the soul and the secrets of heaven.

ÁRVORE SYMBOLIZES: well-being · nature · harmony
protection · strength



CANCUN

Árbore is located in the City of Cancun which is a recognized and awarded vacation destination worldwide.

The beautiful beaches, its cultural diversity and its unlimited recreational possibilities make Cancun a unique place to live or invest.



HUAYACAN AVENUE

Huayacan avenue has become the urban reference of a modern and dynamic city.

In it there is a diverse commercial offer that satisfies all tastes. Nightlife, pubs and restaurants.

Approximately 20 minutes from the airport.





THE IDEAL HARMONY
BETWEEN YOUR LIFE AND NATURE



GROW A SEED OF YOUR NEW LIFE

Árvore **is a symbol of sustainability in balance.**

A vibrant architecture that meets the demands of the contemporary home.



AMENIDADES



MOTOR
LOBBY



LOBBY



COVERED
PARKING



PADDLE
COURT



SWIMMING
POOLS
FOR FAMILIES
AND FOR ADULTS



ROOFTOP
JACUZZI, FIRE PIT, CINEMA
BAR, LOUNGE



BARBECUE
AREA



GYM



COWORKING
& COFFEE



CHILDREN'S
PLAYGROUND



CONTROLLED
ACCESS



GUEST
SUITES



SECURITY
24/7



GARDENS



PET TRACK



CONCIERGE



FIND THE MYSTIQUE
OF A LIFE IN HARMONY





PREMIUM AMENITY

We are the only real estate development in Cancun that offers to be close to those you love most without needing to book a hotel.

We offer you as a premium amenity, suites for your guests, within the same development. Receive your guests and share close to them.

**YOUR GUESTS ALSO HAVE
THEIR SPACE.**



SUSTAINABILITY

We designed a project under the sustainable theme, we let ourselves be embraced by the vegetation and place us at the top of the nature of our monumental icon.

CAPITAL GAINS ON A SMART INVESTMENT

SECURITY

Controlled and planned access with 24-hour surveillance.

LIFESTYLE

We offer premium amenities, the comfort of having everything you need in your own development.

LOCATION

Our location is magnificent, close to all services and just a few steps from Huayacan Avenue.

SIX DEGREES ARCHITECTURE

Clean lines that move to the rhythm of volumes suspended in a grid carefully studied, the result of years of experience in carrying out unique and extraordinary projects.

EXCLUSIVE VISITOR SUITES

Within the package of amenities, we include a unique concept in the market, Short stay suites for your guests. It's like having your own bathroom! hotel!. Your visitors will have access to the experience without losing your privacy. (exclusive benefit for owners not available for rent and subject to administrative conditions).

BEGIN THE TREE
OF YOUR LIFE

APARTMENT | PROTOTYPES

PROTOTYPE ONE BEDROOM

Area: 624.30 ft²

- 1 King bedroom
- 1 full bathroom
- Washing area
- 2 terraces
- Covered parking (1 space)



For those looking for an apartment with a large distribution
at an **affordable price and with excellent income projection.**

*The parking footage is additional to that of the apartment.

PROTOTYPE TWO ROOMS

Area:968.752 ft2

- 2 king bedrooms
- 2 full bathrooms
- 1 half bath
- Washing area
- Terrace
- Covered parking (2 places)

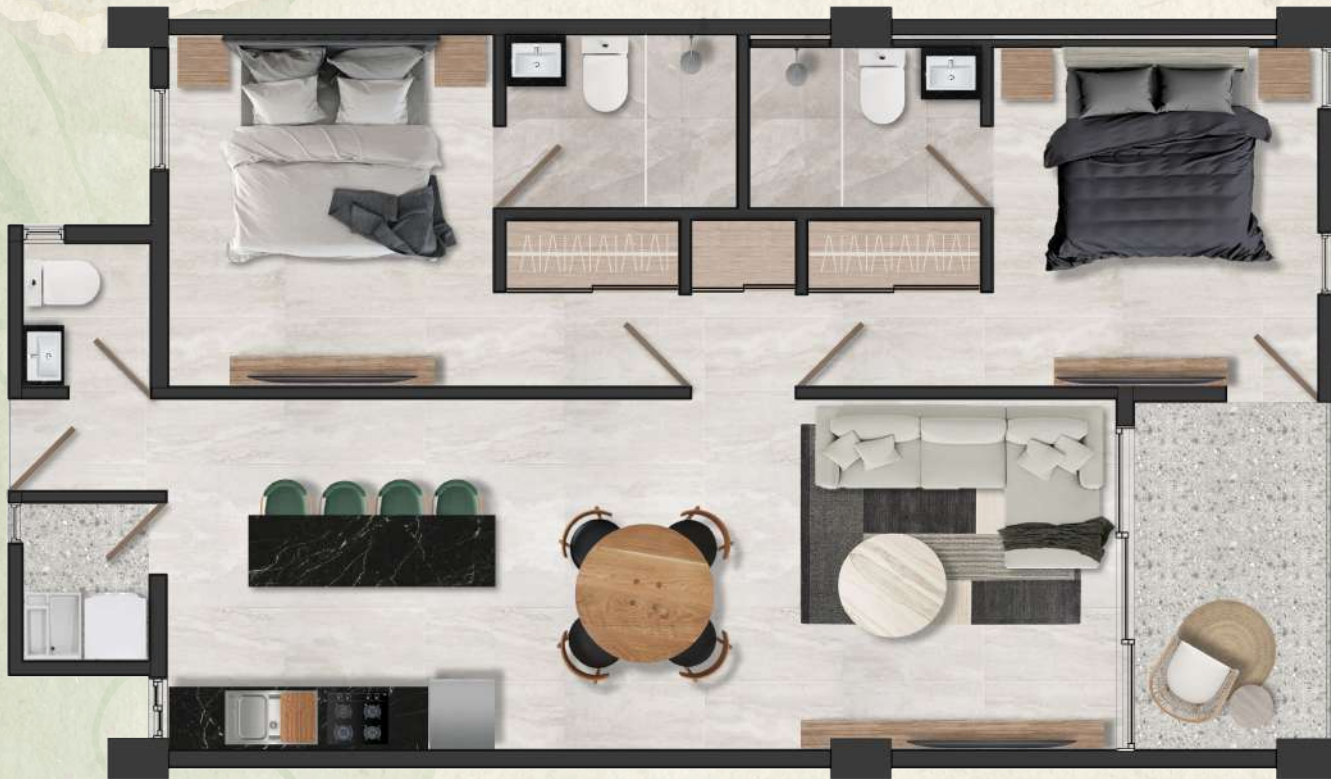

The apartment that has it all!

*The parking footage is additional to that of the apartment.

PROTOTYPE THREE BEDROOMS - GARDEN

Area from: 1646.88 ft2 up to: 1959.03 ft2

- 3 king-size bedrooms
- 3 full bathrooms
- 1 half bath
- Washing area
- garden and terrace
- Covered parking (2 places)



Its family essence defines it, our apartment garden is synonymous with spaciousness and comfort, with a huge private garden and three bedrooms.

*The parking footage is additional to that of the apartment.

PROTOTYPE | PENTHOUSE

Area: 1862.16 ft2



LOW LEVEL

Luxury and high design characterize to our most exclusive unit.

- 3 king-size bedrooms
- 3 full bathrooms
- 1 half bath
- Washing area
- 2 terraces
- private pool
- Covered parking (3 places)



FIRST FLOOR

*The parking footage is additional to that of the apartment.

WHAT YOU FIND IN HUAYACÁN AVENUE



RESTAURANTS



PUBS



MALL



SUPERMARKETS



NIGHT LIFE



20 MIN. APPROXIMATELY
FROM THE AIRPORT.

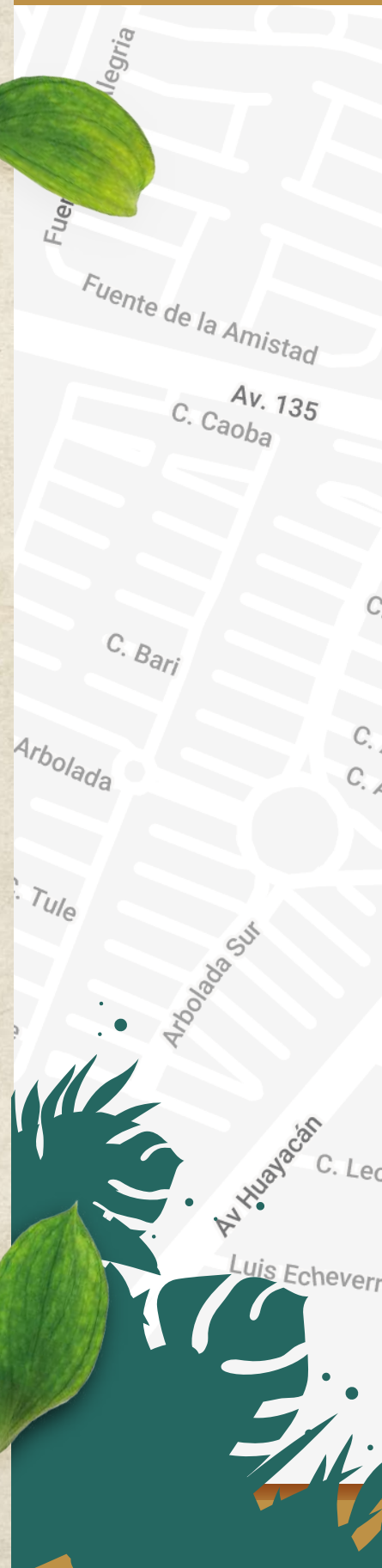



THE CHARACTERISTICS PRESENTED HERE ARE
SUBJECT TO CHANGES AND VARIATIONS WITHOUT
PRIOR NOTICE, SUBJECT TO FINAL
PURCHASE CONTRACT.

IMAGES USED ARE ONLY FOR ILLUSTRATIVE
NATURE AND DO NOT REPRESENT NO LIABILITY
FOR THE DEVELOPER.