

Privada

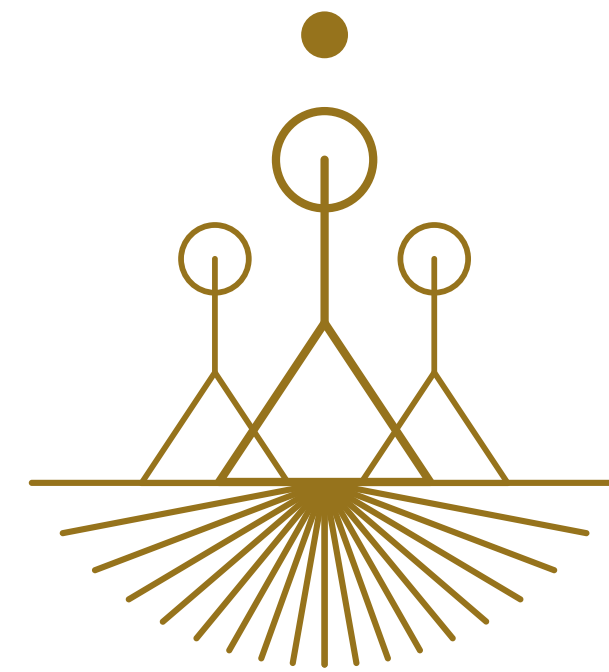

Forest

LOTES UNIFAMILIARES | LISTA DE PRECIOS

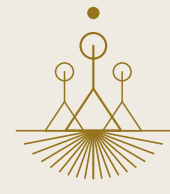
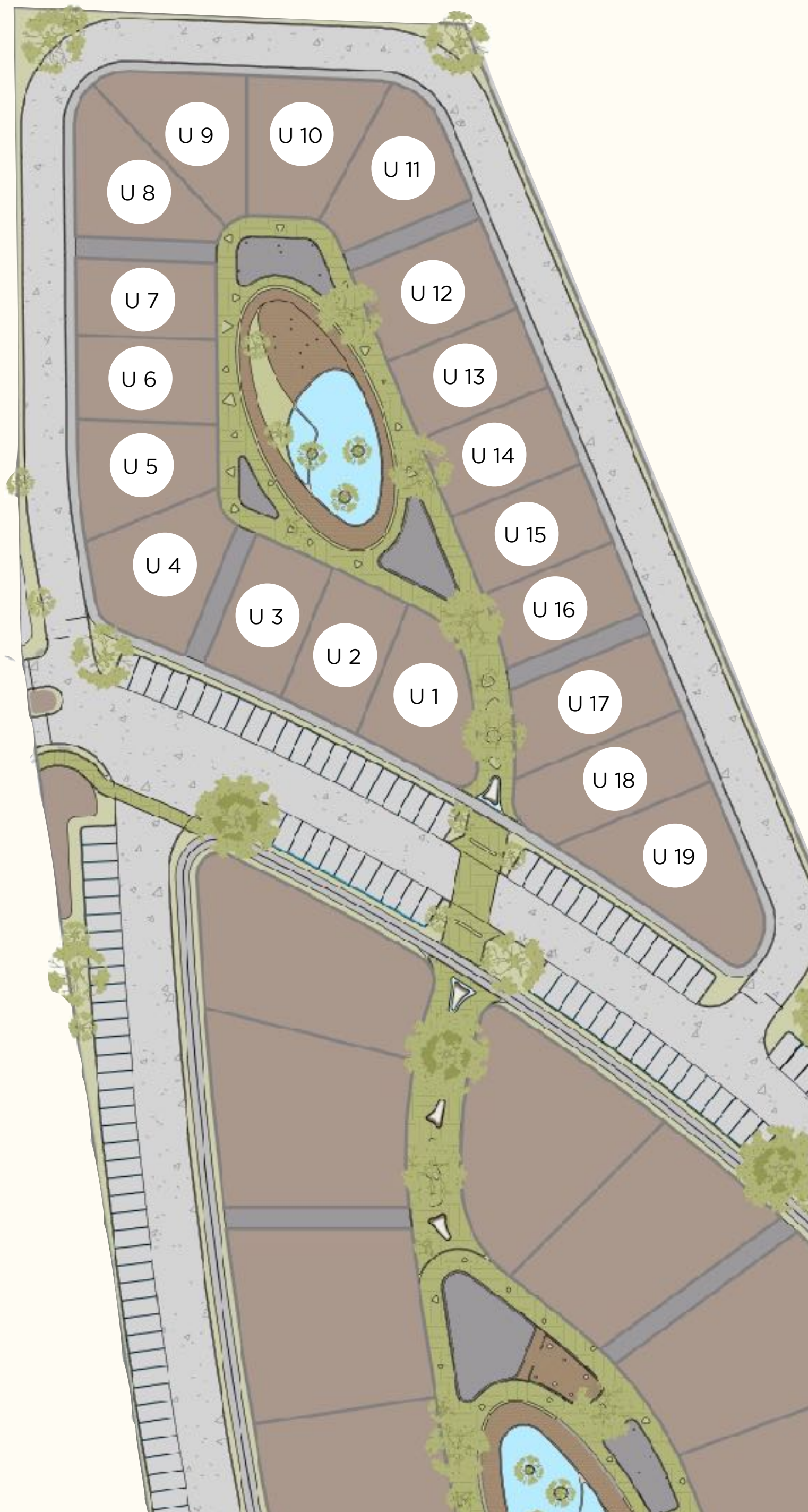

Forest

Especificaciones

Lote	M2	COS 70%	CUS 1.25 **	Rest. F y T	Rest. Lateral	Niveles
U 1	282.00 + 25.00 *	197.40	352.50	3	1	2
U 2	240.00 + 25.00 *	168.00	300.00	3	1	2
U 3	240.00 + 25.00 *	168.00	300.00	3	1	2
U 4	312.00	218.40	390.00	3	1	2
U 5	265.00	185.50	331.25	3	1	2
U 6	240.00	168.00	300.00	3	1	2
U 7	220.00	154.00	275.00	3	1	2
U 8	279.00	195.30	348.75	3	1	2
U 9	283.00	198.10	353.75	3	1	2
U 10	313.00	219.10	391.25	3	1	2
U 11	284.00	198.80	355.00	3	1	2
U 12	277.00	193.90	346.25	3	1	2
U 13	240.00	168.00	300.00	3	1	2
U 14	240.00	168.00	300.00	3	1	2
U 15	240.00	168.00	300.00	3	1	2
U 16	223.00	156.10	278.75	3	1	2
U 17	281.00	196.70	351.25	3	1	2
U 18	282.00	197.40	352.50	3	1	2
U 19	387.00	270.90	483.75	3	1	2

* *Incluyen 2 cajones de estacionamiento, adicionales a los m2 totales del terreno.

** El CUS está calculado de manera que se pueda construir el 100% de la huella que permita el COS en un nivel y el 78% del COS en un nivel adicional.

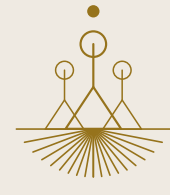

Forest

Lista de Precios MXN

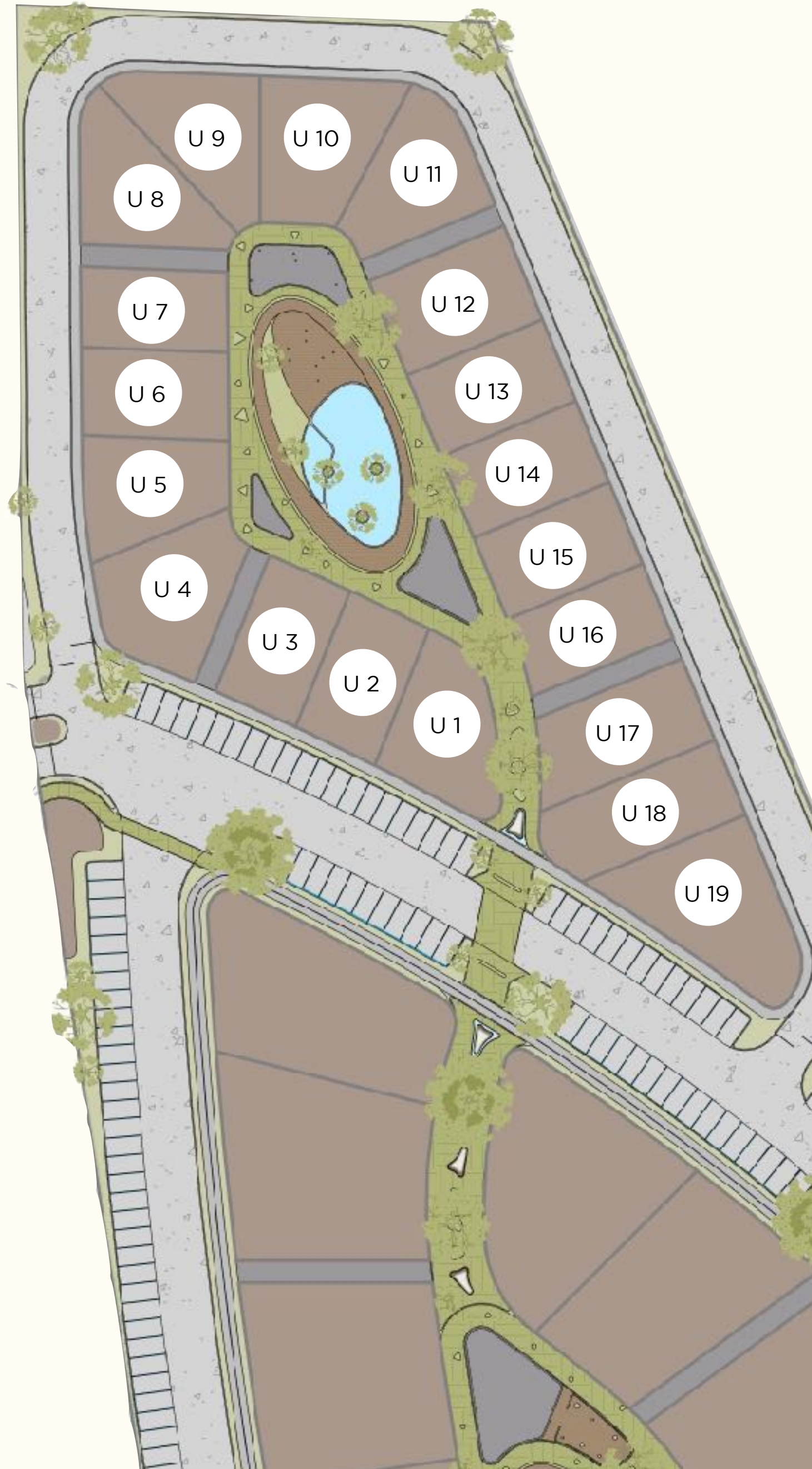

Lote	Precio de Lista 30% - 10% - 60%	10% de Descuento 40% - 20% - 40%	15% de Descuento 50% - 30% - 20%	20% de Descuento 80% - 20%	Disponibilidad
U 1	\$4,200,000.00	\$3,780,000.00	\$3,570,000.00	\$3,360,000.00	Disponible
U 2	\$3,640,000.00	\$3,276,000.00	\$3,094,000.00	\$2,912,000.00	Disponible
U 3	\$3,640,000.00	\$3,276,000.00	\$3,094,000.00	\$2,912,000.00	Disponible
U 4	\$4,300,000.00	\$3,870,000.00	\$3,655,000.00	\$3,440,000.00	Disponible
U 5	\$3,640,000.00	\$3,276,000.00	\$3,094,000.00	\$2,912,000.00	Disponible
U 6	\$3,300,000.00	\$2,970,000.00	\$2,805,000.00	\$2,640,000.00	Disponible
U 7	\$3,000,000.00	\$2,700,000.00	\$2,550,000.00	\$2,400,000.00	Disponible
U 8	\$3,800,000.00	\$3,420,000.00	\$3,230,000.00	\$3,040,000.00	Disponible
U 9	\$3,900,000.00	\$3,510,000.00	\$3,315,000.00	\$3,120,000.00	Disponible
U 10	\$4,300,000.00	\$3,870,000.00	\$3,655,000.00	\$3,440,000.00	Disponible
U 11	\$3,900,000.00	\$3,510,000.00	\$3,315,000.00	\$3,120,000.00	Disponible
U 12	\$3,800,000.00	\$3,420,000.00	\$3,230,000.00	\$3,040,000.00	Disponible
U 13	\$3,300,000.00	\$2,970,000.00	\$2,805,000.00	\$2,640,000.00	Disponible
U 14	\$3,300,000.00	\$2,970,000.00	\$2,805,000.00	\$2,640,000.00	Disponible
U 15	\$3,300,000.00	\$2,970,000.00	\$2,805,000.00	\$2,640,000.00	Disponible
U 16	\$3,060,000.00	\$2,754,000.00	\$2,601,000.00	\$2,448,000.00	Disponible
U 17	\$3,860,000.00	\$3,474,000.00	\$3,281,000.00	\$3,088,000.00	Disponible
U 18	\$4,000,000.00	\$3,600,000.00	\$3,400,000.00	\$3,200,000.00	Disponible
U 19	\$5,300,000.00	\$4,770,000.00	\$4,505,000.00	\$4,240,000.00	Disponible

Condiciones de pago:

- 20% de descuento: 80% enganche, 15% contra entrega física y 5% contra escrituración.
- 15% de descuento: 50% enganche, 30% en 6 mensualidades, 15% contra entrega física y 5% contra escrituración.
- 10% de descuento: 40% enganche, 20% en 6 mensualidades, 35% contra entrega física y 5% contra escrituración.
- Precio de lista: 30% de enganche, 10% en 6 mensualidades, 55% contra entrega física y 5% contra escrituración.